

SOCIETY FOR AMERICAN
ARCHAEOLOGY

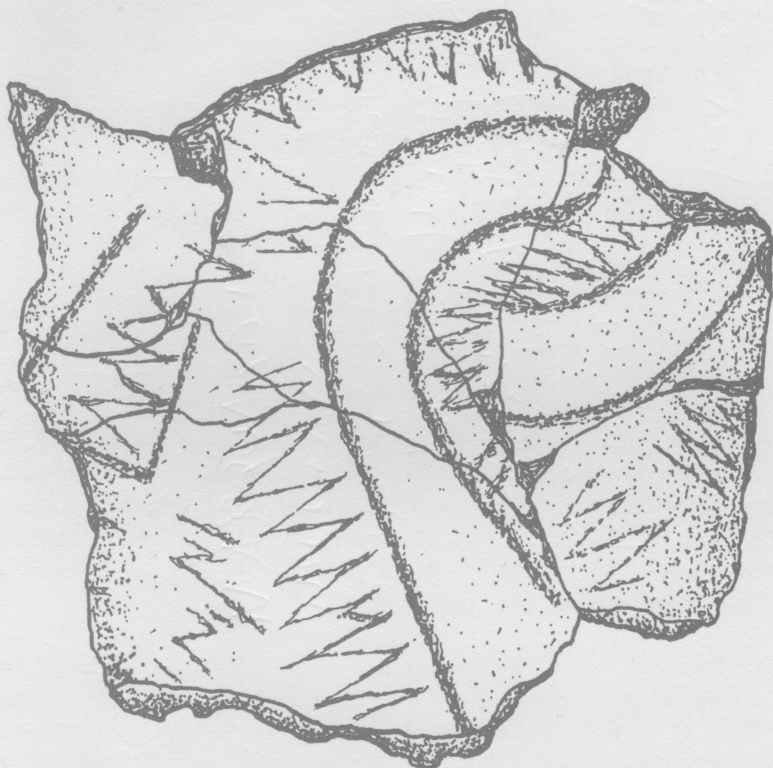

PROGRAM
of the
56th Annual Meeting
April 24-28, 1991
Clarion Hotel—New Orleans, Louisiana

The Society of Professional Archeologists

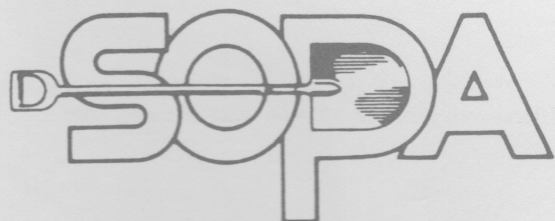

The Society of Professional Archeologists was formed in 1976 from a committee of the Society for American Archaeology. Since its inception, SOPA has grown in size, responsibility, and influence. SOPA is widely recognized for its continuing commitment to promote high standards of research and performance within the profession.

The Society of Professional Archeologists invites and encourages all archeologists to join ranks with the growing number of SOPA applicants and members. For information on how to join, please visit the SOPA information table at this conference, or contact:

David L. Carlson
Anthropology Department
Texas A & M University
College Station, Texas 77843
telephone - (409) 845-4404

PROGRAM of the Fifty-Sixth Annual Meeting Clarion Hotel New Orleans, Louisiana April 24-28, 1991

Contents

General Information	5
Program	19
Exhibitors	64

PITTSBURGH in 1992

Plan to attend the Society's fifty-seventh annual meeting to be held at the Pittsburgh Hilton and Towers, Pittsburgh, Pennsylvania, April 8-12, 1992.

The annual meeting of the Society for American Archaeology provides a forum for the dissemination of knowledge and discussion. The views expressed at the sessions are solely those of the speakers and the Society does not endorse, approve, or censor them. Descriptions of events and titles are those of the organizers, not the Society.

Cover: From the Osceola and Reno Brake Sites, Tensas Parish, Louisiana by Diane Silvia.

Published by the
Society for American Archaeology
808 17th Street NW, Suite 200
Washington DC 20006

Copyright © 1991 by the Society for American Archaeology

All rights reserved. No part of this publication may be reprinted in any form or by any means without prior permission from the publisher.

SOCIETY FOR AMERICAN ARCHAEOLOGY Fifty-Sixth Annual Meeting

1991 SAA PROGRAM COMMITTEE

Timothy A Kohler, Chair
Washington State University

Edgar K Huber
Assistant to the Chair
Washington State University

REVIEWERS

Fekri A Hassan
Washington State University

David R Huelsbeck
Pacific Lutheran University

Patricia McAnany
Boston University

Frank McManamon
National Park Service

Shirley Powell
Northern Arizona University

Elizabeth J Reitz
Georgia Museum of Natural History

J Daniel Rogers
Smithsonian Institution

Carla Sinopoli
University of Wisconsin-Milwaukee

LOCAL ARRANGEMENTS

Tristram R Kidder, Chair
Tulane University

George Bey
Van Button
Michael Commardelle
Rachel Hamilton

OFFICERS OF THE SOCIETY

Jeremy A Sabloff, President
Prudence M Rice, President-Elect
Lynne Goldstein, Secretary
Shereen Lerner, Secretary-Elect
Mark P Leone, Treasurer
J Jefferson Reid, Editor

Executive Board Members

Robert L Bettinger
James Brown
Margaret Conkey
Brian Fagan
Mark J Lynott
Jerald Milanich

Executive Director
and
Assistant Secretary-Treasurer
Jerome A Miller

DIRECTORY OF MEETING ROOMS

The Clarion Hotel New Orleans

1ST FLOOR (LOBBY LEVEL)

Exhibition Hall

MEZZANINE LEVEL

Tulane

CONFERENCE CENTER, 2ND FLOOR

Azalea

Cypress

Fleur de Lis Rooms 1-8

Magnolia

Mimosa

Oak

GRAND BALLROOM, 2ND FLOOR

Salon A

Salon B

Salon C

AUDUBON SUITES, 6TH FLOOR

Audubon A

Audubon B

Audubon C

Audubon D

Audubon E

GENERAL INFORMATION

Abstracts Abstracts of all formal presentations at the meeting are published in *SAA Annual Meeting Abstracts* and may be purchased at the registration desk. Price: Members—\$10.00, Non-Members—\$12.00. Copies of the abstracts may also be ordered prepaid from the Society, 808 17th Street NW, Suite 200, Washington DC 20006.

Business Meeting The Society's annual business meeting will begin at 5:30 PM on Friday in Salon A of the Grand Ballroom.

Convention Office Any problems or special requests during the meeting should be reported to the Convention Office in Fleur de Lis Room 3.

Exhibits Exhibits will be displayed in the Exhibition Hall on the Lobby Level from 9 AM to 6 PM on Thursday and Friday, and 9 AM to 2 PM on Saturday.

Membership Services and Publications SAA publications will be displayed and membership information will be available in the exhibit room during the exhibit hours.

Message and Information Center A self-service message center will be open in the Ballroom Lobby from 5 PM to 8 PM Wednesday, and from 8 AM to 6 PM Thursday through Saturday.

Student and New Member Reception Officers of the Society will host a reception for students, new members and members attending their first annual meeting on Wednesday at 8 PM in the Cypress Room.

Placement Service A placement service will be conducted in the Fleur de Lis Rooms 6 & 7 from 5 PM to 8 PM on Wednesday, 8 AM to 5 PM on Thursday and Friday, and from 8 AM to noon on Saturday. Positions open or wanted may be listed with the service throughout the meeting. Message forms will be provided and box numbers will be assigned for use in the placement service message center.

Registration Registration is required for attendance at all sessions. Registration desks will be open from 5 PM to 8 PM on Wednesday, from 7:30 AM to 3 PM on Thursday, 8 AM to 3 PM on Friday, and 8 AM to noon on Saturday. Individuals who preregistered by March 26 should claim their badges and programs at the advance registration desk. Wearing of the badge is required for admission to all sessions and the exhibits.

Symposia and Sessions Chairs Please maintain the established schedule scrupulously in fairness to persons planning to attend sessions at specific times to hear particular speakers; please pause for the period allotted in the program if a scheduled speaker fails to appear.

Session Smoking Ban Smoking during sessions will not be permitted.

Slide Screening Room A 35mm slide projector and screen will be available in Fleur de Lis Room 4 from Wednesday at 6 PM and thereafter throughout the meeting for presenters who wish to check their slides before presentation.

ANNUAL MEETINGS OF THE SOCIETY FOR AMERICAN ARCHAEOLOGY

Meeting	Place	Date
1st	Andover, Massachusetts	December, 1935
2nd	Washington, DC	December, 1936
3rd	Milwaukee, Wisconsin	May, 1938
4th	Ann Arbor, Michigan	May, 1939
5th	Indianapolis, Indiana	April, 1940
6th	Minneapolis, Minnesota	May, 1941
7th	Cincinnati, Ohio	May, 1942
8th	Because of travel difficulties and other wartime restrictions, the business of the annual meeting in 1943 was conducted by mail by the Executive Committee, whose actions were approved at the next annual meeting.	
9th	Washington, DC	May, 1944
10th	Washington, DC	May, 1945
11th	Indianapolis, Indiana	May, 1946
12th	Ann Arbor, Michigan	May, 1947
13th	Milwaukee, Wisconsin	May, 1948
14th	Bloomington, Indiana	May, 1949
15th	Norman, Oklahoma	May, 1950
16th	Evanston, Illinois	May, 1951
17th	Columbus, Ohio	May, 1952
18th	Urbana, Illinois	May, 1953
19th	Albany, New York	May, 1954
20th	Bloomington, Indiana	May, 1955
21st	Lincoln, Nebraska	May, 1956
22nd	Madison, Wisconsin	May, 1957
23rd	Norman, Oklahoma	May, 1958
24th	Salt Lake City, Utah	May, 1959
25th	New Haven, Connecticut	May, 1960
26th	Columbus, Ohio	May, 1961
27th	Tucson, Arizona	May, 1962
28th	Boulder, Colorado	May, 1963
29th	Chapel Hill, North Carolina	May, 1964
30th	Urbana, Illinois	May, 1965
31st	Reno, Nevada	May, 1966
32nd	Ann Arbor, Michigan	May, 1967
33rd	Santa Fe, New Mexico	May, 1968

34th	Milwaukee, Wisconsin	May, 1969
35th	Mexico City, Mexico	May, 1970
36th	Norman, Oklahoma	May, 1971
37th	Bal Harbour, Florida	May, 1972
38th	San Francisco, California	May, 1973
39th	Washington, DC	May, 1974
40th	Dallas, Texas	May, 1975
41st	St. Louis, Missouri	May, 1976
42nd	New Orleans, Louisiana	April, 1977
43rd	Tucson, Arizona	May, 1978
44th	Vancouver, Canada	April, 1979
45th	Philadelphia, Pennsylvania	May, 1980
46th	San Diego, California	April-May, 1981
47th	Minneapolis, Minnesota	April, 1982
48th	Pittsburgh, Pennsylvania	April, 1983
49th	Portland, Oregon	April, 1984
50th	Denver, Colorado	May, 1985
51st	New Orleans, Louisiana	April, 1986
52nd	Toronto, Ontario, Canada	May, 1987
53rd	Phoenix, Arizona	April, 1988
54th	Atlanta, Georgia	April, 1989
55th	Las Vegas, Nevada	April, 1990

SOCIETY FOR AMERICAN ARCHAEOLOGY

Past Presidents

(*Deceased)

A C Parker *	1935-36	Jesse D Jennings	1959-60
Diamond Jeness *	1936-37	Erik K Reed	1960-61
A V Kidder *	1937-38	Junius Bird *	1961-62
Edgar B Howard *	1938-39	David A Baerreis *	1962-63
Neil Judd *	1939-40	James A Ford *	1963-64
W C McKern *	1940-41	Albert C Spaulding *	1964-65
Glenn Black *	1941-42	Paul S Martin *	1965-66
Nels C Nelson *	1942-43	Joe B Wheat	1966-67
Emil W Haury	1943-44	Gordon R Willey	1967-68
J Alden Mason *	1944-45	H Marie Wormington	1968-69
Carl E Guthe *	1945-46	Ignacio Bernal	1969-70
Frederick Johnson	1946-47	Robert Lister *	1970-71
Douglas S Byers *	1947-48	Richard S MacNeish	1971-72
Waldo R Wedel	1948-49	Charles C DiPeso *	1972-73
J O Brew *	1949-50	Douglas W Schwartz	1973-74
Frank H H Roberts Jr *	1950-51	Charles R McGimsey III	1974-75
James B Griffin	1951-52	Stuart Struever	1975-76
Irving Rouse	1952-53	Raymond H Thompson	1976-77
Gordon F Ekholm *	1953-54	Cynthia Irwin-Williams *	1977-79
Robert Wauchope *	1954-55	Fred Wendorf	1979-81
W Duncan Strong *	1955-56	Richard E W Adams	1981-83
William A Ritchie	1956-57	George C Frison	1983-85
George I Quimby Jr	1957-58	Don Fowler	1985-87
Richard B Woodbury	1958-59	Dena Dincauze	1987-89

AWARDS TO ARCHAEOLOGISTS

Compiled by N Woodbury

The *Viking Fund Annual Awards in Anthropology* (provided by the Wenner-Gren Foundation) consisted of three Viking Fund Medals, with accompanying Viking Fund Prizes of \$1000 each. These were awarded annually 1946-1960 for distinguished research, publication and contribution to science. Scholars were selected by committees of their respective societies—in archaeology by the Society for American Archaeology, in general anthropology by the American Anthropological Association and in physical anthropology by the American Association of Physical Anthropologists.

The awardees in archaeology are:

1946	Alfred Vincent Kidder	1954	William Duncan Strong
1947	John Otis Brew	1955	John Erick Sidney Thompson
1948	Alex Dony Krieger	1956	Junius Bouton Bird
1949	Hallam Leonard Movius, Jr.	1957	James Bennett Griffin
1950	Emil Walter Haury	1958	Jesse David Jennings
1951	Frank Harold Hanna Roberts, Jr.	1959	Irving Rouse
1952	Alfonso Caso	1960	Samual Kirkland Lothrop
1953	Gordon Randolph Willey		

The *Alfred Vincent Kidder Award*, a bronze medallion bearing the likeness of Kidder, was established in 1950 as a tribute to the leadership of A V Kidder by the American Anthropological Association. It has been awarded every three years for eminence in American archaeology, particularly in those fields in which Kidder contributed so much, the Southwestern United States and Middle America.

The awardees have been:

1950	Alfred Marston Tozzer	1971	Richard Stockton MacNeish
1953	Earl Halstead Morris	1974	Gordon Randolph Willey
1956	Samuel Kirkland Lothrop	1977	Emil Walter Haury
1959	Charles Corradino Di Peso	1980	William Timothy Sanders
1962	Tatiana Proskouriakoff	1983	Samuel Watson Smith
1965	Neil Merton Judd	1986	Ignacio Bernal
1968	Paul Sidney Martin	1989	Richard B Woodbury

The *Distinguished Service Award* of the Society for American Archaeology was established in 1975. In 1980 it was decided to make the award annually. It consists of a framed inscribed citation.

The awardees have been:

1975	Carl Haley Chapman	1985	Emil Walter Haury
	Charles Robert McGimsey III	1986	Waldo R Wedel
1980	Gordon Randolph Willey	1987	William A Ritchie
1981	Albert Clanton Spaulding	1988	Richard B Woodbury
1982	Jesse David Jennings		and Nathalie F S Woodbury

1983	Hannah Marie Wormington	1989	George Irving Quimby
1984	James Bennett Griffin	1990	Fred Wendorf

The *Fryxell Award for Interdisciplinary Research* was set up by the Society for American Archaeology in 1977 in memory of Roald Fryxell whose career exemplified so well the crucial role of interdisciplinary cooperation in archaeology. The award, consisting of a citation and a medallion, was to be presented annually; however, no award was made in 1984.

The awardees have been:

1978	C Vance Haynes	1985	Roger T Saucier
1979	Peter J Mehringer	1986	Donald K Grayson
1980	James B Griffin	1987	Richard I Ford
1981	Karl W Butzer	1988	David M Hopkins
1982	David J Baerreis	1989	Joseph B Lambert
1983	John E Guilday (posthumously)	1990	Patty Jo Watson
1984	(No award)		

The *Crabtree Award* was established by the Society for American Archaeology in 1985 to recognize major contributions to American archaeology by individuals who have had little if any formal training in archaeology and little if any wage or salary as an archaeologist. The award is named after Don Crabtree of Twin Falls, Idaho, who made significant contributions to the study of lithic technology and whose dedication to archaeology was a lifelong personal and financial commitment.

The awardees have been:

1985	Clarence H Webb, MD	1989	J B Sollberger
1987	Leonard W Blake	1990	Ben C McCary
1988	Julian Dodge Hayden		

The SAA Dissertation Prize is awarded to archaeologists just entering the profession whose doctoral theses are judged to be particularly outstanding. The prize consists of Life Membership in the Society and is awarded at the Annual Meeting of the Society.

The awardees have been:

1988	Judith A Habicht Mauche	1990	David J Bernstein
	Harvard University		State University of New York at Stony Brook

BUSINESS & SOCIAL EVENTS

MONDAY, APRIL 22

8:00 AM	U.S. Forest Service— Magnolia
8:00 AM	BLM Cultural Resources Program Leaders Meeting— Fleur de Lis 2
8:00 AM	National Archeological Database Regional Coordinators Meeting— Fleur de Lis 5

TUESDAY, APRIL 23

8:00 AM	U.S. Forest Service— Magnolia
8:00 AM	Soil Conservation Service— Azalea
8:00 AM	Army Corps of Engineers— Mimosa
8:00 AM	UN-Reno Seminar—Nuts & Bolts: Memoranda of Agreement (MOA's), Programmatic Agreements (PA's) and No Adverse Effect Determinations— Audubon A
8:00 AM	UN-Reno Seminar—Archives: An Introduction— Audubon B
8:00 AM	BLM Cultural Resources Program Leaders Meeting— Fleur de Lis 2
8:00 AM	National Archeological Database Regional Coordinators Meeting— Fleur de Lis 5
9:00 AM	National Science Foundation— Fleur de Lis 1

WEDNESDAY, APRIL 24

8:00 AM	SAA Executive Board— Oak
8:00 AM	SAA Government Affairs Committee— Fleur de Lis 2
8:00 AM	U.S. Forest Service— Magnolia
8:00 AM	BLM Cultural Resources Program Leaders Meeting— Fleur de Lis 8
8:00 AM	Soil Conservation Service— Azalea
8:00 AM	Association of Transportation Archeologists— Cypress
8:00 AM	Army Corps of Engineers— Mimosa
8:00 AM	UN-Reno Seminar—Nuts & Bolts: Memoranda of Agreement (MOA's), Programmatic Agreements (PA's) and No Adverse Effect Determinations— Audubon A
8:00 AM	UN-Reno Seminar—Archives: An Introduction— Audubon B
9:00 AM	National Science Foundation— Fleur de Lis 1
9:00 AM	National Association of State Archeologists— Audubon D
9:00 AM	National Park Service— Audubon C
7:00 PM	Saucier Meeting— Azalea
8:00 PM	SAA Public Relations Committee— Fleur de Lis 5
8:00 PM	Student and New Member Reception— Cypress

THURSDAY, APRIL 25

8:00 AM	SAA Committee on Public Archaeology— Fleur de Lis 1
8:00 AM	Society of Professional Archeologists Board Meeting— Oak
9:00 AM	<i>Latin American Antiquity</i> Editorial Board— Fleur de Lis 5
11:30 AM	Council of Presidents Luncheon (By invitation only)— Azalea
12 Noon	Society of Professional Archeologists Business Meeting— Oak

- 12 Noon Society for Archaeological Sciences Executive Board Meeting—**Fleur de Lis 1**
- 12 Noon Films & Videos—See Registration Packet for schedule of showings—**Fleur de Lis 5**
- 2:00 PM Society of Professional Archeologists Board Meeting—**Oak**
- 4:00 PM Public Education Committee—Open Forum—**Azalea**
- 5:00 PM Society for Archaeological Sciences Business Meeting—**Fleur de Lis 1**
- 7:00 PM Reception—Cash Bar—Prefunction Area, Tulane & Grand Ballrooms
- 7:00 PM SAA Committee Member Reception—Cypress
- 8:00 PM Plenary Session—**Grand Ballroom**

FRIDAY, APRIL 26

- 8:00 AM Archeology Section of American Anthropological Association Executive Committee Meeting—**Azalea**
- 9:00 AM SAA Finance Committee—**Fleur de Lis 1**
- 9:00 AM Save the Past for the Future Steering Committee—**Fleur de Lis 8**
- 1:00 PM Foundation for American Archaeology—Task Force—**Fleur de Lis 1**
- 2:00 PM Council of Affiliated Societies—**Fleur de Lis 5**
- 4:00 PM Public Education Committee—**Azalea**
- 4:00 PM Past Annual Meeting Program Chairs—**Fleur de Lis 8**
- 5:30 PM SAA Annual Business Meeting—**Salon A, Grand Ballroom**
- 8:00 PM Women in Archaeology—Cash Bar Reception—**Audubon D**

SATURDAY, APRIL 27

- 8:00 AM SAA Executive Board—**Azalea**
- 8:00 AM Teacher Workshop—**Oak**
- 8:00 AM Inter-Society Working Group on Public Education—**Fleur de Lis 1**
- 9:00 AM Society for Historical Archaeology Board Meeting—**Fleur de Lis 8**
- 10:00 AM SOPA Application Workshop—**Fleur de Lis 5**
- 10:00 AM American Society for Conservation Archaeology Executive Committee Meeting—**Fleur de Lis 1**
- 1:00 PM American Society for Conservation Archaeology Business Meeting—**Fleur de Lis 1**
- 6:00 PM Gumerman Meeting—Cypress

SUNDAY, APRIL 28

- 8:00 AM Summit Meeting—**Azalea**
- 8:00 AM Teacher Workshop—**Oak**

SPECIAL EVENTS

With the exception of the *History of New Orleans* walking tour, participation in special events is by pre-registration only. However, since space may be available on some tours and luncheons, interested persons should inquire at the Convention Office.

Walking Tours: Free walking tours of the French Quarter and surrounding parts of New Orleans are available for registrants and their families; each tour takes from 90 minutes to two hours, and requires between one and two hours of walking. The tours vary in registration requirements so please note the group size limitations. **Please Note:** weather conditions in New Orleans are variable and often severe. Sudden, heavy rainfalls may occur so come prepared. Tour lengths and distances may vary with weather and other factors. All walks except the Faubourg Promenade begin at the National Park Service Folklife and Visitors Center, 916 N Peters Street in the French market; maps will be available at the SAA Information Desk in the Clarion Hotel.

City of the Dead—Tour 1. Visit St. Louis Cemetery No. 1, the oldest in the city, and explore the social customs that surround burial in these "cities of the dead". Group limit 10 per tour, one tour per day. Reservations are required.

Tour times are as follows:

Tour 1-A	Wed 4/24	9:30 AM	Tour 1-D	Sat 4/27	9:30 AM
Tour 1-B	Thu 4/25	9:30 AM	Tour 1-E	Sun 4/28	9:30 AM
Tour 1-C	Fri 4/26	9:30 AM			

History of New Orleans—Tour 2. Relive the history of New Orleans from its humblest beginnings as a small outpost of French rule. The tour will emphasize the historical events and ethnic and cultural diversity that helped to make present-day New Orleans unique among American cities. Group size may be limited; available daily at 10:30, 1 PM and 3 PM. No reservations required.

Tour de Jour—Tour 3. The French Quarter is the longest settled area in the Mississippi Delta Region. The flow of history through its streets brought together diverse cultures which met and mingled in this unique environment. A wealth of fascinating historical and cultural topics spring from this richness and are featured on a rotating basis in this changing series of walks. Group limit 30 per tour, one tour per day. Reservations are required. Tour times are as follows:

Tour 3-A	Wed 4/24	11:30 AM	Tour 3-D	Sat 4/27	11:30 AM
Tour 3-B	Thu 4/25	11:30 AM	Tour 3-E	Sun 4/28	11:30 AM
Tour 3-C	Fri 4/26	11:30 AM			

Faubourg Promenade—Tour 4. A trip into "American Territory" in uptown New Orleans. Visit the Garden District, one of the finest residential areas of modern-day New Orleans and once the center of early American culture in

New Orleans. The tour will be met at the Corner of St. Charles and First Streets. Take the St. Charles Avenue streetcar (board near the intersection of Canal Street and St. Charles Avenue) and exit at First Street. Plan for 30 minutes minimum travel time. The streetcar fare is \$.80 each way. Group limit 30 per tour. Reservations are required. Tour times are as follows:

Tour 4-A	Wed 4/24	2:30 PM	Tour 4-D	Sat 4/27	2:30 PM
Tour 4-B	Thu 4/25	2:30 PM	Tour 4-E	Sun 4/28	2:30 PM
Tour 4-C	Fri 4/26	2:30 PM			

Riverboat Trips—Tour 5. The Steamboat Natchez takes a 22 mile round trip journey down the Mississippi allowing people to see from the boat the port of New Orleans, historic Chalmette National Battlefield (scene of the Battle of New Orleans), and numerous sites along the Mississippi. This is a scenic and fun way to see the mighty Mississippi and to explore the past and present of the New Orleans riverfront. Two cruises are available. Cost is \$8.75 per adult, \$5.00 for children 6-12; children under 6 go free. Minimum number per tour is 20 persons. The tour leaves from the Jax Brewery at the foot of Jackson Square. Tour times are as follows:

Tour 5-A	Wed 4/24	2:30 PM
Tour 5-B	Sun 4/28	11:30 AM

Aquarium Tours—Tour 6. The Aquarium of the Americas is a new addition to the New Orleans waterfront and is located at the foot of Canal Street. It features special exhibits on aspects of American waters, specifically the Caribbean, the Amazon Basin, the Gulf of Mexico and the Mississippi River. Additional exhibits include Penguins, and educational opportunities involving sight, sound and the opportunity to touch various sea creatures. The aquarium is a great place to take the family or just to see some of the wonders of the waterways of the Americas.

The SAA has arranged for several group-rate tours of the Aquarium of the Americas. Three group rate tours are available at a cost of \$6.40 per adult and \$3.40 for children 12 and younger. Minimum group size for these tours is 15 persons. The regular admission price for the aquarium is \$7.00. Tour times are as follows:

Tour 6-A	Wed 4/24	2:00 PM
Tour 6-B	Sat 4/27	11:00 AM
Tour 6-C	Sun 4/28	10:00 AM

A tour of both the Aquarium and the Audubon Zoo, with boat transportation is also available, but group rates cannot be provided. These tours and the boat ride can be broken up so that one could take in the aquarium one day and the boat trip and Audubon Zoo on a second day. This tour option is available daily for \$22.00 per adult and can be arranged through the New Orleans Steamboat Co.; their ticket booth is located at the Aquarium.

Marsh Archaeology Tour—Tour 7. Two tours of the archaeology of the Louisiana marshes are being offered. These tours will provide an opportunity to see the environment and archaeology of the Bayou Des Allemands area of southeast Louisiana. Maximum group size for these tours will be 20 persons, with a 10 person minimum. The tours will start at the hotel and provide transportation to the boat launching site on the west bank of the Mississippi. Shallow draft boats will be used to give tour goers the opportunity to explore sites along the shores of Lake Salvadore and Bayou Des Allemands. These guided tours will emphasize the prehistoric cultures and ecology of the region, and will also provide an opportunity to see and explore the mystery and beauty of the Louisiana marsh. Each tour will last approximately five hours and includes transportation to and from the boat launch and the boat trip itself. No food will be provided. Those wishing to go should be aware of the unpredictability of the weather and be prepared prior to departure. Severe weather on the date(s) of the tour(s) will necessitate cancellation. Cost for the tour will be \$15.00 per person. Tour times are as follows:

Tour 7-A	Sat 4/27	8:00 AM
Tour 7-B	Sun 4/28	8:00 AM

Round Table Luncheon—Issues for Women as Professionals in Anthropology

Friday, April 26—12:00—1:30 PM

Co-Organizers: Margaret W. Conkey, Christine A. Hastorf, Margaret Nelson

Recent studies indicate that women still do not advance as professional archaeologists in the ways and numbers that are expected. The factors and processes that appear to contribute to this are complex and varied. This Round Table Luncheon is oriented explicitly toward women graduate students and other pre-professional women archaeologists, and it is designed to give interested students an opportunity to discuss ideas and concerns with one or more active senior female archaeologists.

There will be eight round-tables, each with a different topic for discussion. Each table will be "hosted" by one or two different archaeologists, and will accommodate up to eight places. Preference for seating will be given to women who are currently graduate students in archaeology and/or who are just beginning research, contract, teaching, or other professional positions in archaeology.

Opening remarks will be by Joan Gero (University of South Carolina) on "Issues and Implications of the Sociopolitics of Archaeology".

Table One: Issues in Considering Federal/Private Employment
Leader: Ruthann Knudson (National Park Service)

Table Two: Issues in Undertaking Fieldwork Outside North America
Leaders: Christine Hastorf (University of Minnesota)
Ruth Tringham (University of California, Berkeley)

- Table Three:** Issues in Publishing: Where and How to Publish
Leader: Patty Jo Watson (Washington University)
- Table Four:** Issues in Getting Grants and the Research Process
Leader: Carole Kramer (University of Arizona)
- Table Five:** Fieldwork, Families, and Careers
Leader: Margaret Nelson (SUNY Buffalo)
- Table Six:** The Academic Career: Options, Tracks, and Tenure
Leaders: Julie Stein (University of Washington)
 Joan Gero (University of South Carolina)
- Table Seven:** Issues in the Workplace: The "Chilly Climate" for Women—
 As Students, as Leaders, as Professionals
Leader: Alison Wylie (University of Western Ontario)
- Table Eight:** Issues in the Job Market: Resumes, Experience, Interviews
Leaders: Dena Dincauze (University of Massachusetts)
 Margaret Conkey (University of California, Berkeley)

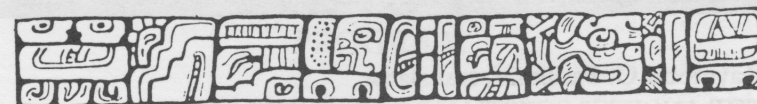

Vision and Revision in Maya Studies

Edited by Flora S. Clancy and Peter D. Harrison
 Cloth: \$40.00

Precolumbian Population History in the Maya Lowlands

Edited by T. Patrick Culbert and Don S. Rice
 Cloth: \$40.00

Land and Politics in the Valley of Mexico

A Two Thousand Year Perspective
Edited by H. R. Harvey
 Cloth: \$35.00

Exploring the Hohokam

Prehistoric Desert Peoples of the American Southwest
Edited by George J. Gumerman
 Cloth: \$45.00

Recovering the Past

Richard A. Gould
 Cloth: \$24.95

Archaeology and the Methodology of Science

Jane H. Kelley and Marsha Hanen
 Paper: \$15.95

The Ethics of Collecting Cultural Property

Edited by Phyllis Mauch Messenger
 Cloth: \$32.50 Paper: \$15.95

Maya Resistance to Spanish Rule

Time and History on a Colonial Frontier
Grant D. Jones
 Paper: \$19.95

At bookstores, or call (505) 277-4810 FAX 1-800-622-6887

UNIVERSITY OF NEW MEXICO PRESS
 ALBUQUERQUE, NEW MEXICO 87131-1591



Raymond O. Faulkner, translator

THE ANCIENT EGYPTIAN BOOK OF THE DEAD

Edited by Carol Andrews

A collection of religious and magical texts that were placed in the tombs of important Egyptians for the purpose of helping the dead pass safely through the dangers of the underworld to achieve an afterlife of bliss. \$19.95 paper

Michael A. Hoffman

EGYPT BEFORE THE PHARAOHS

The Prehistoric Foundations of Egyptian Civilization

A comprehensive overview of present evidence for the prehistoric and early dynastic development of Egyptian civilization. \$15.95 paper

T. G. H. James

ANCIENT EGYPT The Land and Its Legacy

A sturdy paperback edition of James' beautifully illustrated volume that traces the enormous richness and variety of ancient Egyptian culture by following the Nile from the Delta region to Upper Egypt and Nubia. \$20.95 paper

Masoud Kheirabadi

IRANIAN CITIES Formation and Development

Kheirabadi's wide-ranging look at the formation of Iranian cities in which he considers the influences of the physical environment and trade and historical events, as well as religious and sociopolitical structures on the form and morphology of the cities of Iran. (July) \$27.50 cloth

Richard J. Perry

WESTERN APACHE HERITAGE

People of the Mountain Corridor

Perry's innovative use of ethnographic data to reconstruct Apachean history and culture sheds much light on the origins, dispersions, and relationships of the Apachean peoples. \$37.50 cloth \$17.95 paper

Albert Szabo and Thomas J. Barfield

AFGHANISTAN

An Atlas of Indigenous Domestic Architecture

Based on a survey of Afghanistan's indigenous domestic architecture that was carried out in 1974-1976 prior to the Soviet invasion, this book offers the most comprehensive record of Afghan dwelling types currently available. (June) \$80.00 cloth

Please visit our booth at the annual meeting.



UNIVERSITY OF TEXAS PRESS

BOX 7819 AUSTIN, TEXAS 78713

1(800)252-3206

PROGRAM

WEDNESDAY EVENING APRIL 24, 1991

[1] Invited Symposium: Research in the Lower Mississippi Valley: The State of the Art

Tulane

Organizer and Chair: Webb, Malcolm C

Participants

- 7:30 Webb, Malcolm; Introduction.
- 7:45 Gagliano, Sherwood M; Gaia Archaeology of the Mississippi Delta System.
- 8:05 Jackson, H Edwin; Alternative Perspectives on the Poverty Point Culture.
- 8:25 Weinstein, Richard; The Tchula Period in the Lower Mississippi Valley and Adjacent Coastal Zone: A Brief Summary.
- 8:45 Fritz, Gayle; Recent Investigations into Lower Mississippi Valley Subsistence.
- 9:05 Kidder, Tristram R; Current Research in Troyville and Coles Creek Cultures in the Mississippi Valley.
- 9:25 Giardino, Marco; Current Issues Relating to the Late Prehistoric Cultures of the Mississippi River Delta.

THURSDAY MORNING APRIL 25, 1991

[101] Sponsored Symposium: Analysis of Large Archaeomagnetic Data Sets

Audubon A

Organizers & Chairs: Sternberg, R S & W L Deaver

Participants

- 8:00 Eighmy, Jeffrey, Donald L Blakeslee & Douglas R Mitchell; Chronometry of Archaeomagnetic and Radiocarbon Dates From Pueblo Grande.
- 8:20 Sternberg, Robert, Richard C Lange & Barbara A Murphy; A Large Archaeomagnetic Data Set From Las Colinas: Factors Affecting Precision and Accuracy.
- 8:40 Deaver, William; A Chronology of the Hohokam Pioneer Period and a Model of Archaeomagnetic Secular Variation During the First Millenium A.D. for the US Southwest.
- 9:00 Doyel, David E & Jeffrey Eighmy; Refining the Archaeomagnetic Chronology for the Bonito Phase in the Chaco Canyon Region, New Mexico.
- 9:20 Wolfman, Daniel, Kenneth G Hirth & George Hasemann; Archaeomagnetic Dating in the Cajon Dam Project Area, Central Honduras.
- 9:40 Tarling, Donald H; The British Directional Archaeomagnetic Data Base.
- 10:00 Discussants: Evans, M E & R E Taylor

[102] Sponsored Symposium: Archaeology in the National Historic Landmark Program

Audubon B

Organizers and Chairs: Brose, David S & Richard Waldbauer

Participants

- 8:20 Levy, Benjamin; National Historic Landmarks Survey.
- 8:40 Brose, David; The SAA-NPS Memorandum: High-Profile Reciprocity.
- 9:00 Barnes, Mark R; Nominating National Historic Landmarks: The Example of Jaketown.
- 9:20 Grumet, Robert S; Historic Contact in the Northeast NHL Theme Study.
- 9:40 BREAK
- 10:00 Ames, Kenneth; Nominating the Sunken Village Site as a National Historic Landmark.

- 10:20 Morton, Susan; National Historic Landmarks Under Siege: Two Examples From Alaska.
 10:40 Discussant: Waldbauer, Richard

[103] Symposium: Political Meals in the Andes

Grand Ballroom Salon B
 Organizers & Chairs: Gero, Joan M & Christine A Hastorf

Participants

- 8:00 Quilter, Jeffrey; Food, Agriculture, and Society in Late Preceramic Peru.
 8:20 Umlauf, Marcelle; Public and Private Ceremonial Feasting at the Initial Period Site of Cardal, Central Coast of Peru.
 8:40 Bruhns, Karen Olsen; Refreshments Will Be Served.
 9:00 Arsenault, Daniel; Food, Politics, and Rituals in Moche Society.
 9:20 Gero, Joan M; Feasts and Females: Gender Ideology in Political Contexts.
 9:40 Burke, Robin; Llama Figurines and Ritual Feasts.
 10:00 Sutherland, Cheryl Ann; Ritual Drinking at Tiwanaku in the Middle Horizon.
 10:20 Hastorf, Christine A; Fighting and Food in the Inka Conquest.
 10:40 Topic, John R & Theresa Lange Topic; Food Preparation, Public Feasting, and Redistribution.
 11:00 Discussants: Matos, Ramiro, Jerry Moore & Elizabeth Brumfiel

[104] Symposium: Variations on Death: Prehistoric and Early Historic Mortuary Practices in the Eastern Woodlands

Audubon C
 Organizers and Chairs: Wilkinson, Richard & Lynne Sullivan

Participants

- 8:00 Wilkinson, Richard & Susan J Bender; Curation, Burial, and Mortuary Ceremony at a Late Woodland Site in Michigan.
 8:20 Schurr, Mark; Angel Site Mortuary Studies: Past, Present, and Future Directions.
 8:40 Tench, Patricia; Intraregional Mortuary and Biological Variation in Fort Ancient.
 9:00 Sullivan, Lynne; Earthworks and Mortuary Behavior in Southwestern New York.
 9:20 Sempowski, Martha L; Some Possible Explanations for a Shift in the Orientation of Graves Among the Early Historic Seneca.
 9:40 Humpf, Dorothy; Mortuary Behavior in 16th-Century Northwest Georgia: The King, Little Egypt, and Etowah Sites.
 10:00 Discussant, Brown, James

[105] Symposium: Economic Patterns of the Middle Paleolithic and the Middle Stone Age

Audubon D
 Organizers: Chase, Philip G & John F Hoffecker
 Chair: Cruz-Urbe, Kathryn

Participants

- 8:00 Rolland, Nicolas; Middle Paleolithic Emergence: Another Major Turning Point?
 8:20 Otte, Marcel & Marylène Patou; Middle Paleolithic Food Economy: Views Across Europe.
 8:40 Chase, Philip; "Ethnoarchaeology" and Middle Paleolithic Subsistence.
 9:00 Dibble, Harold L, Barbara Roth & Michel Lenoir; Raw Material Economy in the Quina Mousterian of Combe-Capelle (Dordogne, France).
 9:20 Farizy, Catherine & J Jaubert; Middle Paleolithic Specialized Sites: The Case of Western France—French Pyrenees.
 9:40 Gamble, Clive & Francis Wenban-Smith; The Organization of Levalloisian Technology in the Lower Thames Area, Southeast England.
 10:00 Bosinski, Gerhard; Middle Paleolithic Settlement Patterns, Based on Central European Data.
 10:20 Conard, Nicholas; Subsistence in the Central Rhine Valley During the Middle Paleolithic.

- 10:40 Hoffecker, John, Gennady Baryshnikov & Olga Potapova; Mousterian Foraging Strategy in the South Russian Plain, Crimea, and Northern Caucasus.
 11:00 Cruz-Urbe, Kathryn; The Exploitation of Seals in the Middle Stone Age of South Africa.
 11:20 Wallsmith, Debbie; Intersite Relationships in the Middle Stone Age of Southern Africa.
 11:40 Pope, Geoffrey; New Discoveries and Regional Paleolithic Differentiation in the Far East.

[106] Symposium: Perspectives on the Social and Economic Contexts of Prehistoric Craft Specialization

Grand Ballroom Salon C
 Organizers and Chairs: Cagle, Chantal & George Michaels

Participants

- 8:00 Ehrenreich, Robert M; Metalworking in Iron Age Britain: Hierarchy or Anarchy.
 8:20 Cagle, Chantal; Faux Pots: Household Versus Specialty Production of Glastonbury Ware in Iron Age Britain.
 8:40 Munns, Ann M & Jeanne E Arnold; The Organization of Shell Bead Production on California's Northern Channel Islands.
 9:00 Yerkes, Richard; The Context of Craft Specialization in Cahokia Mississippian Society.
 9:20 Clark, John; Statecraft and State Crafts: A Reconsideration of Mesoamerican Obsidian Industries.
 9:40 Healan, Dan M; From the Quarry Pit to the Trash Pit: Models of Toltec Obsidian Exploitation.
 10:00 Sievert, April; Elite Specializations: Craft Production and Ceremonial Performance Among the Lowland Maya.
 10:20 Tosi, Maurizio; Sectorial Growth and Craft Specialization: Two Perspectives to Interpret the Organization of Production From the Archaeological Record.
 10:40 Reese-Taylor, Kathryn; The Effects of Changing Socioeconomic and Religious Institutions on Ceramic Production in Northern Belize During the Late Preclassic.
 11:00 Abrams, Elliot; Architecture and the Division of Labor at Late Classic Copan, Honduras.
 11:20 Freter, AnnCorinne; A Reconstruction of the Late Classic Rural Ceramic Production System in the Copan Valley, Honduras.
 11:40 Discussant: Earle, Timothy

[107] Symposium: Folsom Archaeology: Early Holocene Paleoecology

Tulane
 Organizer & Chair: Jodry, Margaret

Participants

- 8:00 Haynes, C Vance; Clovis-Folsom-Midland-Plainview Geochronology.
 8:20 Ferring, Reid; Late Quaternary Geology, Paleoenvironments and Paleoindian Archaeology in North-Central Texas.
 8:40 Stokes, Stephen; Luminescence Dating of Some Archaeologically Significant Dune and Fluvial Deposits From the Llano Estacado.
 9:00 Davis, Owen; *Sporormiella*: An Indicator of the Clovis-Folsom Biomass Collapse?
 9:20 Graham, Russell; Folsom-Age Vertebrate Faunas From the Great Plains.
 9:40 Todd, Lawrence; Variation in Folsom-Age Bison Assemblages: Implications for Interpretations of Human Action.
 10:00 BREAK
 10:20 Miller, Susanne J; Early Holocene/Folsom Period Environments of the Intermontane West: View From the Snake River Plain.
 10:40 Davis, Leslie, Sally T Greiser & John P Albanese; Indian Creek and MacHaffie: Folsom Campsites in the Elkhorn Range, Northern Rocky Mountains.
 11:00 Collins, Michael B; Occurrences of Folsom-Midland Components in Rockshelters in the South-Central United States.
 11:20 Meltzer, David; Status and Ranking at Folsom.

[108] Symposium: Archaeological Investigations at Tosawih, a Great Basin Quarry

Cypress
 Organizers: Elston, Robert G & Christopher Raven
 Chair: Callaway, Cashion

Participants

- 8:00 Callaway, Cashion; White Knives, Cinnabar, and Gold.
 8:20 Raven, Christopher; Not By Bread Alone: Diet and Domicile in the Tosawihi Countryside.
 8:40 Schmitt, Dave N; Points, Ground Stone, and Bone: Human Subsistence in the Tosawihi Quarries.
 9:00 Leach, Melinda; Residentiality and Site Function at Tosawihi.
 9:20 Drews, Michael P & Kathryn Ataman; Tosawihi Chronologies: From Then to Entirety.
 9:40 Carambelas, Kristopher & Shelly Raven; Actualistic Quarrying Experiments at Tosawihi.
 10:00 Bloomer, William & Eric Ingbar; Opalite Procurement and Processing: Economics, Mobility, and Reduction.
 10:20 Ataman, Kathryn & Steve Botkin; Smaller and Farther: Biface Technology and Transport at Tosawihi and Beyond.
 10:40 Dugas, Daniel P; Modeling Site Formation Processes at the Tosawihi Quarries, Nevada.
 11:00 Elston, Robert G; Vicissitudes of Lithic Procurement: Modeling Strategies at Tosawihi Quarries.
 11:20 Discussants: Binford, Lewis R & Richard A Gould

[109] Symposium: Methodological Aspects of Interdisciplinary Research at Teotihuacan

Grand Ballroom Salon A
 Organizer: Manzanilla, Linda
 Chair: Cowgill, George L

Participants

- 8:00 Cabrera Castro, Rubén; The Temple of Quetzalcoatl Project: Its Structure and General Results.
 8:20 Cowgill, George L & Oralia Cabrera; Implications of 1988 Excavations in and Near the Platform Covering the West Face of the Feathered Serpent Pyramid, Teotihuacan.
 8:40 Sugiyama, Saburo; The Discovery of the Central Burial at the Temple of the Feathered Serpent, Teotihuacan.
 9:00 Serrano Sanchez, Carlos, Martha Pimienta Merlín & Alfonso Gallardo Velázquez; Spatial Distribution by Age and Sex of the Burials in the Temple of Quetzalcoatl: Biocultural Implications.
 9:20 Barba, Luis & Agustin Ortiz; Surface/Excavation: Feedback and Archaeological Implications.
 9:40 Manzanilla, Linda; Contrasting Methods of Activity Area Research at Teotihuacan.
 10:00 Spence, Michael; Tlailotlacan, the Oaxaca Barrio of Teotihuacan.
 10:20 McClung de Tapia, Emily & Judith Zurita-Noguera; Integrated Botanical Studies: Experiences at Teotihuacan, Mexico.
 10:40 Valadez, Raúl; Contributions to Faunal Use and Consumption at Teotihuacan.
 11:00 Rattray, Evelyn; Archaeological and Technological Studies of Thin Orange Ware.
 11:20 Discussants: Manzanilla, Linda & Emily McClung de Tapia

[110] Symposium: Environment, Economy, and Cultural Change in the Khabur Basin, Syria

Magnolia
 Organizer & Chair: Hole, Frank

Participants

- 8:00 Hole, Frank; The Problem, the Sites, and the Excavations.
 8:20 Hole, Bonnie; Data Analysis for Collaborative Research.
 8:40 McCorriston, Joy; Vegetation and Land-Use in the Khabur Basin.
 9:00 Zeder, Melinda & Susan R Arter; Animal Utilization in the Khabur Drainage From the 6th to 2nd Millennium BC.
 9:20 Kouchoukos, Nicholas; Time Trends in Khabur Basin Ceramics.
 9:40 Johnson, Gregory A; Rescue Research and Long-Term Variation in Northern Syria.
 10:00 Discussant: Blackman, M James

[111] Poster Symposium: Episodic Change in Grasshopper Prehistory

Exhibition Hall
 Organizers: Reid, J Jefferson & Barbara Klie Montgomery

Participants

- 1 Nash, Stephen E; Paleodemography and Climate in the Mountains of East-Central Arizona AD 1250-1400.
- 2 Neupert, Mark; Mogollon Archaeoastronomy? Evidence From the Grasshopper Region.
- 3 Doolittle, Christopher J & Mark Neupert; Settlement Analysis Through GIS: A Mogollon Example.
- 4 Welch, John R & Joseph Ezzo; Changing Diet and Subsistence in the Grasshopper Region.
- 5 Montgomery, Barbara K; Changes in Household Organization.
- 6 Triadan, Daniela & Maria Nieves Zendeno; Temporal Variability in Ceramic Assemblages From the Grasshopper Region.
- 7 Lorentzen, Leon; Change in Projectile Point Form and Function.

[112] Symposium: Native American History and Archaeology in Southern New England

Audubon E
 Organizers & Chairs: Feder, Kenneth L & Kevin McBride

Participants

- 8:00 Savulis, Ellen-Rose; Eighteenth Century Native American Settlement and Subsistence Patterns: The Simons Site, Mashpee, Massachusetts.
 8:20 Feder, Kenneth; The Lighthouse: A Multicultural Village in Northwestern Connecticut.
 8:40 McBride, Kevin; "Ancient and Crazier": Native Lifeways in the Historic Period.
 9:00 Rubertone, Patricia E; When Less is More: Reconstructing Native Societies From Mortuary Evidence.
 9:20 Robinson, Paul; Creating an Indian-Centered History: Autonomy and Unity in 17th-Century Narragansett Society.
 9:40 Johnson, Eric S; The Politics of Marriage and Alliance in 17th-Century Native Southern New England.

[113] General Session: Analysis of Pollen and Microfossils

Audubon A
 Chair: Schoenwetter, James

Participants

- 11:00 Rovner, Irwin & William Middleton; Microfossil Evidence of Livestock Management Strategies and Dietary Patterns in Herbivore Dental Tartar.
 11:15 Jones, John G; Pollen as a Key to the Identification of Maya Agricultural Systems.
 11:30 Schoenwetter, James; The Paleoenvironmental Context of Salado Archaeology.
 11:45 Gish, Jannifer W; Large Fraction Pollen Scanning in the Study of Archaic and Protohistoric Sites.

[114] General Session: Native American Issues

Audubon C
 Chair: Klesert, Anthony

Participants

- 10:40 Shannon, Janette C & Gregory Hess; Joining Forces to Combat Burial Vandalism: A Case History.
 10:55 Garza, Christina E; The History of a Reburial Policy.
 11:10 Tonetti, Alan C; Ghost Dancing in the Nineties: Research, Reburial, and Resurrection Among the Dead in Ohio.
 11:25 Klesert, Anthony L; Why Archaeology Needs Native Americans, and How Best to Get Them.
 11:40 Blukis Onat, Astrida R; Archaeology, Culture, and Cannibalism.

[115] General Session: Analysis of Use-Wear

Audubon E
 Chair: Skibo, James

Participants

- 10:20 Skibo, James; Ceramic Attrition and Pottery Use: An Ethnoarchaeological and Experimental Study.
- 10:35 LeMoine, Genevieve; Use-Wear on Bone and Antler Tools: An Application of Tribological Principles.
- 10:50 Smith, Susan Kirkpatrick & Della Collins Cook; Mesolithic to Modern Dental Wear at Franchthi Cave, Greece.
- 11:05 Jensen, Helle J; Grain Cultivation in Early Neolithic Denmark: What Do the Tools Tell?
- 11:20 Hirst, K Kris; Shell Games: Freshwater Naiad Shell as Raw Material for Tools.
- 11:30 Bullock, Margaret; Functional Analysis of Bone Tools From Aggregated and Hamlet Pueblo Sites in Southwestern Colorado.
- 11:40 Shifrin, Lisa; Microwear Examination of Ceramic Tools From a Late 9th-Century Anasazi Site.
- 11:50 Kimball, Larry R; The Function of Hopewell Blades From Icehouse Bottom and Garden Creek Sites.

[116] General Session: Irrigation and Water Storage: Analyses and Implications

Magnolia

Chair: Nichols, Deborah

Participants

- 10:40 Nichols, Deborah, Michael W Spence & Mark D Borland; Early Irrigation at the Ancient City of Teotihuacan: New Evidence From the Oaxaca Barrio.
- 10:50 Scarborough, Vernon & Gary Gallop; A Water Storage Adaptation in the Maya Lowlands.
- 11:05 Carpenter, Maureen & Elena Kourembana; *Agua, Aguades*, and *Chultunes*: Water Management in the Yucatan.
- 11:20 Morrison, Kathleen; Supplying the City: The Role of Reservoir Irrigation in an Indian Urban Landscape.
- 11:35 Abbott, David & Jerry Howard; Paleohydraulics and Ceramic Exchange: Structure and Interaction in Hohokam Irrigation Communities.

[117] General Session: Posters: Southwest, Great Basin, and Mesoamerica

Exhibition Hall

Participants

- 9 Rautman, Alison E; Coping With Environmental Variability: Social Networks and Ceramic Exchange in Central New Mexico.
- 10 Shaffer, Brian S & Harry J Shafer; Modified Rabbit and Hare Innominates From the Mimbres Valley, New Mexico
- 11 Ellis, G Lain; Preliminary Evidence of Arroyo-Mouth Farming and Water Control at a Classic Mimbres Village.
- 12 Adams, Christopher D, John W Hohmann & Diane E White; The Catacombs of Casa Malpais.
- 13 Gann, Douglas; View From a Platform Mound.
- 14 Cooper, Laurel M; Spatial Syntax in Chaco Canyon.
- 15 Amick, Daniel; Comparison of Methods Used in Modeling Biface Reduction Trajectories.
- 16 Hockett, Bryan; Two Ledges Chamber: Investigations in Small Mammal Taphonomy.
- 17 Hoover, Robert L; Excavations at Mission San Antonio, California.
- 18 Hall, Barbara Ann; Residence Units and Residential Mounds in Mesoamerica.
- 19 Sabloff, Jeremy A & Gair Tourtellot; The Ancient Maya City of Sayil, Yucatan, Mexico: The 1983-1988 Field Research.
- 20 Johnston, Kevin; Late Classic Maya Nonplatformed Residential Structures at Itzan, Guatemala.
- 21 MacKinnon, J Jefferson, Jeffery Olson & Emily May; "Megalithic" Maya Architectural Features at the Site of Chacben Kax, Alabama Plantation, Stann Creek District, Belize.
- 22 Hoopes, John; Archaeological Survey of the Golfo Region, Southern Costa Rica.
- 23 Reed, David; Stable Isotopes and Ancient Mayan Diet at Copan, Honduras.
- 24 Fowler, William R; Archaeology and Social History at Tacuscalco, El Salvador.

[118] General Session: Researching Subsistence and Settlement Systems

Mimosa

Chair: Simmons, Alan H

Participants

- 8:00 Snyder, Sandra L; Distinctive Site Distribution Patterns in Northern and Central Areas of the Western Oregon Cascade Range.
- 8:15 Lothrop, Jonathon & Frances Pickin; Prehistoric Settlement in the Hudson Highlands of New York.
- 8:30 Emerson, Alice M; An Evaluation of Using Sheep, Caribou, and Bison Body Part Utility Models in Analyses of Bone Assemblages of Other Species.
- 8:45 Brown, Gary M & Jannifer W Gish; New Insights on Late Archaic Subsistence and Settlement in the Four Corners Area.
- 8:55 Capone, Patricia & Margaret Schoeninger; Food or Feathers: Amino Acid Racemization Analysis of Turkey Bone.
- 9:05 Guderjan, Thomas; Maya Settlement in Northwestern Belize.
- 9:15 de Montmollin, Olivier; Political Centralization in Four Classic Maya Polities.
- 9:30 Smyth, Michael P & Christopher D Dore; Large Site Archaeology at Sayil, Yucatan, Mexico: The Organization of a Pre-Hispanic Maya Community.
- 9:40 Johnston, Susan A; Prehistoric Irish Rock Art and Its Relationship to Settlement.
- 9:55 Murray, Matthew; Landscape as Mindscape: 2000 Years of Settlement History at Kelheim, Niederbayern.
- 10:10 Batten, David C; The Effect of Transport Efficiency on the Development of Cities in Late Preindustrial Europe.
- 10:25 Schofield, John A; New Ideas for Urban Archaeology: Recent Work in the City of London.
- 10:40 Montet-White, Anta; Late Paleolithic Settlements in Central Europe at the Time of the Last Glacial Maximum.
- 10:55 Chang, Claudia & Perry A Tourtellotte; The Ethnoarchaeology of Seasonal Pastoral Transhumance in Northern Greece.
- 11:10 Verhaaren, Bruce; Discriminant Analysis at Kurban Höyük: The Spatial/Functional Analysis of a Bronze Age Village.
- 11:25 Kudlik, John J & Dennis Dirkmaat; Diet and Faunal Remains: An Archaeological Examination of a 15th-Century Medieval Danish Fishing Camp.
- 11:40 Schwartz, Charles A; Archaeozoological Perspectives on Dalmatian Prehistory.
- 11:55 Simmons, Alan; Dwarfed Pleistocene Fauna and the First Settlers of Cyprus.

THURSDAY AFTERNOON APRIL 25, 1991**[201] Symposium: Folsom Archaeology: Early Holocene Human Adaptation**

Tulane

Organizer & Chair: Stanford, Dennis

Participants

- 1:30 Frison, George; Northwestern Plains—Central Rocky Mountains Folsom Subsistence Strategies.
- 1:50 Jodry, Margaret A; Folsom Sites From the Rocky Mountains of Colorado: Settings and Site Structure at Bison Kill-Butchery and Campsite Localities.
- 2:10 Stanford, Dennis; Folsom Mobility as Reflected by the Distribution of Lithic Raw Materials in Sites From Montana to Texas.
- 2:30 Ingbar, Eric E; Site Occupational Histories and Chipped Stone Production at the Hanson Folsom Locality, Wyoming.
- 2:50 Hofman, Jack; Sites, Localities, and Isolated Finds: Developing a Regional Interpretation of Folsom Variability on the Southern Plains.
- 3:10 BREAK
- 3:30 Mallouf, Robert; The Adair-Steadman Site: Perspectives on Folsom Settlement in Upland Sand Sheets of the Texas Rolling Plains.

- 3:50 Tunnell, Curtis; Folsom Knapping Uniformity at the Adair-Steadman Site.
 4:10 Wheat, Joe Ben; The Chispa Creek Folsom Site, Culberson County, Texas.
 4:30 Discussant: Dillehay, Thomas D

[202] Poster Symposium: Microartifacts: Little Things Answering Big Questions

Exhibition Hall

Organizers: Mueller Pierce, Felice & Sarah Sherwood

Participants

- 1 Mueller Pierce, Felice; Identifying Occupations: A New Technique Based on Lithic Microartifact Weathering.
- 2 Sherwood, Sarah C; Spatial Analysis of a Mississippian House Floor: A Full Scale Attack.
- 3 Linse, Angela; The Big, the Little, and the Left Behind: The Story From Macro- and Microartifacts.
- 4 Kornbacher, Kim; Microartifacts From Shell Middens: Another Piece of the Puzzle.
- 5 Wilhelmssen, Kris H; Microartifact Assemblages: Estimation, Graphic Representation, and Interpretation.
- 6 Teltser, Patrice & Joseph J Kovacic; Plowzone Structure of a Middle Woodland Settlement From Microartifacts.
- 7 Baumler, Mark Frederick; Small-Sized Lithic Debitage: Micro Doesn't Have to Mean Microscopic.

[203] General Session: Eastern North America

Cypress

Chair: Walker, Karen Jo

Participants

- 1:30 Walker, Karen; Fishing Artifacts of Southwest Florida's Maritime Calusa: Recognition and Significance.
- 1:45 Bourque, Bruce J & Harold Krueger; Dietary Reconstruction of Prehistoric Maritime Peoples of Northeastern North America: Faunal vs Stable Isotopic Approaches.
- 2:00 Heckenberger, Michael J & James B Petersen; Early Evidence for Horticulture in Northern New England: Recent Investigations at the Skitchewaug Site, Springfield, Vermont.
- 2:15 Doershuk, John F; Quantitative and Graphical Spatial Analysis of a Hearth-Based Depositional Model for the Koster Site, Greene County, Illinois.
- 2:30 Weidl, Eric; Tuberculosis Mortality Rates and the Averbuch Site: Implications for Paleodemographic Theory and Research.
- 2:45 Hughes, Richard E; The Sources of Hopewell Obsidian.
- 3:00 Jeske, Robert J; The Late Woodland to Mississippian Transition in the Upper Midwest.
- 3:15 BREAK
- 3:30 Novick, Andrea; A Study of Carolina Piedmont Archaeological Survey Strategies.
- 3:45 Hendricks, Aubrey; Cahokian Influence: Direct Control and Independent Trade.
- 4:00 Pollack, David, William E Sharp & A Gwynn Henderson; New Perspectives on Fort Ancient Cultural Developments.
- 4:15 Hunt, Eleazer D; Using Geographic Information Systems (GIS) as a Methodology for Refining Catchment Analysis: An Example Utilizing Late Woodland Period Sites.
- 4:30 Lensink, Stephen C; Explanations of Dietary Shifts in Mill Creek Culture Based on Age Structure of Data for White-Tailed Deer.
- 4:45 Riggs, Brett; Site Structure of Removal Period (1835-1838) Cherokee Indian Households in Southwestern North Carolina.
- 5:00 Brown, Kenneth & Kristine N Tidwell; Archaeology and African-American Culture: The Magician/Curer's Cabin at the Jordan Plantation, Texas.

[204] General Session: Western North America

Audubon E

Chair: Van West, Carla

Participants

- 1:30 O'Connell, James F, Kristen Hawkes & Nicholas B Jones; What Do Clovis Kill Sites Really Represent? Skeptical Comments From the Hadza Perspective.
- 1:45 McVickar, Janet L; Human Subsistence and Vegetation Change at Cowboy Cave.
- 1:55 Loendorf, Lawrence, Julie Francis & Ronald I Dorn; A Rock Art Chronology for the Bighorn Basin, Wyoming and Montana: Varnish and 14-C Dating as an Aid to Rock Art Studies.
- 2:10 Rowe, Marvin, Jon Russ & Marian Hyman; Radiocarbon Dating of Pictographs.
- 2:20 Hunt, Nicola; Ceramic Assemblages as Indicators of Human Mobility.
- 2:35 Bernard-Shaw, Mary & Chester W Shaw; Early Ceramic Period Occupations in the Tucson Basin: New Research and Issues in Southern Arizona Prehistory.
- 2:50 Powell, Shirley & Cecily Coddington; How Agricultural Were They? A Citations Analysis of Southwestern Agricultural Dependence.
- 3:05 Lebo, Cathy; Adapting to Harvest Variability: Maize Yields on Prehistoric Black Mesa.
- 3:15 Mitchell, Douglas; Burials and Households: A Preliminary Spatial Analysis of a Large Hohokam Cemetery.
- 3:25 BREAK
- 3:40 Schlanger, Sarah; Places for the Living, Place for the Dead: Mortuary Variability in the Northern Southwest.
- 3:55 Allison, James R; Style, Exchange, and Social Networks in the Northern Southwest.
- 4:10 Peterson, Jane & David Abbott; Indices of Salado Polychrome Ceramic Production: The Evidence From Pueblo Grande.
- 4:25 Van West, Carla; Modeling Prehistoric Climatic Variability and Agricultural Production in Southwestern Colorado: A GIS Approach.
- 4:40 Lycett, Mark T; Limited Activities and Continuous Distributions: Toward an Archaeology of Anasazi Landscapes.
- 4:55 Baugh, Timothy G & Frank Eddy; Prehistoric Field Systems in the Galisteo Basin.

[205] General Session: Greater Southwest and Mesoamerica

Magnolia

Chair: Nelson, Ben A

Participants

- 1:30 Schiavitti, Vincent; Prehistoric Chalchihuites Settlement System: Settlement Hierarchy and Mines.
- 1:45 Nelson, Ben A, J Andrew Darling & David A Kice; Temple Ritual and Human Remains at La Quemada, Zacatecas, Mexico.
- 2:00 Foster, Michael S; Archaeology of the Zape Area, Durango, Mexico.
- 2:15 Bradley, Ronna J; Developing Methods for Measuring Interaction: Exchange Relationships in Northwestern Mesoamerica and the Southwest.
- 2:30 Staley, Barbara; Unpacking the Present to Clarify the Past: Politics and Economics in Michoacan, Mexico.
- 2:40 Minnis, Paul & Michael Whalen; Casas Grandes in Regional Context.
- 2:55 Stark, Barbara L, Lynette Heller & Michael D Glascock; New Archaeological Obsidian Source Data From South-Central Veracruz, Mexico.
- 3:05 Rust, William F; Preclassic Ceramics and Figurines From La Venta.
- 3:20 Speaker, John S; Settlement and Agricultural Potential in Ancient Veracruz, Mexico.
- 3:30 BREAK
- 3:40 Love, Michael & Thomas L Jackson; Middle Preclassic Obsidian Exchange in Pacific Guatemala.
- 3:55 Kolb, Charles C; Tales of Teotihuacan: The Status of Ceramic Technological Analyses on Ten Classic Period Wares.
- 4:10 Feinman, Gary, Scott Fedick & Linda Nichols; Shell Ornament Production in Mexico's Southern Highlands: The Results From an Exploratory Season in Ejutla.
- 4:20 Wingard, John D; The Role of Soils in the Developmental Sequence at Copan, Honduras.
- 4:35 Fahmel-Beyer, Bernd; Paleomagnetism at Monte Alban, Oaxaca: The Orientation of Architecture as an Alternative Dating Method.
- 4:50 Misner, Elizabeth J; The Stones of Monte Alban.
- 5:05 Zeitlin, Robert N; The Hypothesis of Late Formative Period Monte Alban Imperialism in Light of Recent Excavations at Laguna Zope, Oaxaca.

[206] Symposium: Multidisciplinary Research at St-Césaire: Implications for the Middle/Upper Paleolithic Transition in Poitou-Charentes, France

Grand Ballroom Salon B

Organizers: Backer, Anna & François Lévêque

Chair: Backer, Anna

Participants

- 1:30 Miskovsky, Jean-Claude & François Lévêque; The Sedimentology of St-Césaire and Its Contribution to Paleoclimatic Models of the Würm II-III Interstadial and the Early Würm III.
- 1:50 Leroyer, Chantal & Arl Leroi-Gourhan; The Pollen Sequence at St-Césaire: Its Contribution to the Understanding of the Middle/Upper Paleolithic Transition.
- 2:10 Lévêque, François; The Castelperronian Industries of St-Césaire (Charente-Maritime, France).
- 2:30 Guilbaud, Michel; Macrodebitage From Castelperronian Levels at St-Césaire (Charente-Maritime, France).
- 2:50 Vandermeersch, Bernard; The St-Césaire Skeleton: Natural Preservation or Human Intervention?
- 3:10 BREAK
- 3:30 Lavaud-Girard, Françoise; Macrofauna From Castelperronian Levels at St-Césaire (Charente-Maritime, France).
- 3:50 Patou-Mathis, Marylène; A Taphonomic and Paleoethnographic Study of the Fauna Associated With the Neandertal of St-Césaire, Charente-Maritime.
- 4:10 Backer, Anna M; The Site Structure of La Roche à Pierrot, St-Césaire: Changing Uses of a Rockshelter.
- 4:30 Mercier, Norbert; Dating the Site of St-Césaire (Charente-Maritime, France).
- 4:50 Discussants: White, Randall & Olga Soffer

[207] Symposium: The Emergence of Cultural Complexity on the West Coast of North America

Grand Ballroom Salon C

Organizers: Fagan, Brian M & Maschner, Herbert D G

Chair: Maschner, Herbert D G

Participants

- 1:30 Knecht, Richard A & Richard H Jordan; The Development of Ranked Eskimo Societies on Kodiak Island, Alaska.
- 1:50 Maschner, Herbert D G; Circumscribed Abundance: Cultural Complexity on the Northern Northwest Coast.
- 2:10 Ames, Kenneth A; Prehistoric Social and Cultural Developments on the Southern Northwest Coast.
- 2:30 Beaton, John M; Extensification and Intensification in Northern California Prehistory.
- 2:50 Arnold, Jeanne E; Currents, El Niños, Elites, and Exchange: Intensified Production of Valuables and Transformation of an Island Economy.
- 3:10 Lambert, Patricia M & Phillip L Walker; Physical Anthropological Evidence for the Evolution of Social Complexity in Coastal Southern California.
- 3:30 Fagan, Brian M; The Emergence of Cultural Complexity on the West Coast of North America.

[208] General Session: South America

Audubon C

Chair: Athens, J Stephen

Participants

- 1:30 Smith, Robert Kimball; A New Holocene Climatic Reconstruction for the Pacific Coast of Northwestern South America.
- 1:45 Staller, John E; The Platform Mound at the Late Valdivia Site of La Emerenciana and Its Significance to the Development of Complexity in Western South America.

- 2:00 Aleto, Thomas; A Protohistoric Mortuary Complex at Ceibo Grande, La Puna Island, Ecuador.
- 2:10 Brockington, Donald L & David M Pereira H; The Formative Period Project in Cocabamba, Bolivia: 1988 and 1989.
- 2:20 Netherly, Patricia J; Prehistoric Occupation of Interfluvial Zones in Ecuadorean Amazonia.
- 2:35 Masucci, Maria; The Utility of Utilitarian Wares: Guangala Phase Ceramic Chronology in Southwest Coastal Ecuador.
- 2:50 Pintar, Elizabeth; Archaic Hunters and Herders of the Andean Puna.
- 3:05 Kuznar, Lawrence; The Faunal Record of Andean Pastoral Sites.
- 3:20 BREAK
- 3:35 Athens, J Stephen; Early Agriculture and Settlement in Northern Highland Ecuador.
- 3:45 Mathews, James Edward; Prehispanic Settlement and Agriculture in the Middle Tiwanaku Valley, Bolivia.
- 4:00 Albarracin-Jordan, Juan; Prehispanic Agriculture and Settlement Dynamics in the Lower Tiwanaku Valley, Bolivia.
- 4:15 Webster, Ann DeMuth; Prehistoric Exploitation of Fauna in the Tiwanaku Valley, Bolivia.
- 4:30 Gumerman, George, IV; The Nobility Eat Wealthy, While the Commoners Go Wild: Subsistence Variation Among Socioeconomic Groups at Pacatnamu, Peru.
- 4:45 Moore, Jerry; New Approaches to Old Buildings: Recent Analyses of Andean Monumental Architecture.

[209] Symposium: The Native American Tobacco Complex: Origins, Development, and Analysis

Audubon D

Organizer: Winter, Joseph C

Chair: Adams, Karen R

Participants

- 1:30 Winter, Joseph; Prehistoric and Historic Native American Tobacco Use: An Overview.
- 1:50 Adams, Karen R; Identification Criteria of *Nicotiana* (Tobacco) Parts: Flowers, Capsules, Seeds, Leaves, and Stems.
- 2:10 Holloway, Richard G & Glenna Dean; Morphological Studies of New Mexico Solanaceae Pollen.
- 2:30 Cummings, Linda Scott; Examination of Modern Tobacco Pollen and Identification of Prehistoric Tobacco Pollen in Southwestern Colorado.
- 2:50 Gager, Forrest L, Jr; Studies of the History of Tobacco Use—Nicotine as Chemical Marker.
- 3:10 Wagner, Gail E; Tobacco in Prehistoric Eastern North America.
- 3:30 BREAK
- 3:50 Adair, Mary J; Tobacco on the Plains: Historical Use, Ethnographic Accounts, and Archaeological Evidence.
- 4:10 Toll, Mollie S & Karen R Adams; Assessing Ancient Tobacco (*Nicotiana*) Use in the Prehistoric Southwestern United States.
- 4:30 von Gernet, Alexander; Tobacco Use in Prehistoric North America: Evidence From Cross-Cultural Continuities Surviving in Historic and Ethnographic Records.
- 4:50 Samet, Jonathan & Joseph C Winter; The Adverse Health Effects of Tobacco Use in America: Past and Present.
- 5:10 Discussant: Crawford, Gary

[210] Symposium: African Transformations: Recent Perspectives on the Later Prehistory of Africa

Audubon A

Organizer & Chair; Stahl, Ann

Participants

- 1:30 Stahl, Ann; British Imperialism in the Volta Basin: Historic Change and Prehistoric Implications.
- 1:50 MacEachern, Scott; Wandala Since AD 1400: The Development of a Sudanic State.

- 2:10 Robertshaw, Peter; Integrating Archaeology and History: New Perspectives on State Formation in Uganda.
 2:30 Vogel, Joseph; The Owner of the Land: Kin-Chartered Coalitions in the Prehistory of Southwestern Zambia.
 2:50 Marshall, Fiona; East African Hunter-Gatherers and Their Neighbors.
 3:10 Denbow, James; Ethnography and Archaeology: The Case of the Kalahari San.
 3:30 Discussant: Wright, Henry

[211] Symposium: The Scientific and Public Uses of BLM Lands: New Directions and Opportunities for CRM Work

Audubon B
 Organizers: King, Robert E & John Douglas
 Chair: King, Robert E

Participants

- 1:30 Cannon, William J & Mary F Ricks; BLM Cultural Resource Management Data: Resources for Archaeological Research.
 1:50 Stumpf, Gary & Aline LaForge; The Colorado City Project: Turning a Problem Into a Prize.
 2:10 Amme, Brian C; Promoting and Funding Research Proposals on Public Lands: An Example From Eastern Nevada.
 2:30 Smith, Gary P & Jerry Clark; Archaeological Research and the Cost-Share Program in Montana.
 2:50 Tratebas, Alice M; Rock Art Research in Wyoming.
 3:10 Lytle, John C; Paleoindian to Historic Chinese: The Volunteer Program in the Idaho Bureau of Land Management Shoshone District.
 3:30 King, Robert E; Cooperation in the "Frozen North": New Work in the Unalakleet River Drainage.

[212] Symposium: Spatial Relations: Social Proximity, Interaction, and Distance

Grand Ballroom Salon A
 Organizer and Chair: Kramer, Carol

Participants

- 1:30 Stone, Glenn; Concentric Rings and Circles of Friends: Movement Minimization and Social Affiliation in the Spatial Organization of Kofyar Agriculture.
 1:50 Horne, Lee; Testing Least (Social) Effort on an Iranian Plain.
 2:10 Cameron, Catherine M; The Relationship of Residential Patterns to the Oraibi Split.
 2:30 Longacre, William A & Miriam Stark; Decoration, Kinship, and Space: A Ceramic Example From the Kalinga.
 2:50 Stark, Miriam; From Sibling to Suki: Social and Spatial Relations in Kalinga Pottery Exchange.
 3:10 BREAK
 3:30 Kramer, Carol & John Douglas; Ceramics, Caste, and Kin: Spatial Distributions in Rajasthan, India.
 3:50 Rothschild, Nan A; Ethnicity vs Efficiency in 18th-Century New York City.
 4:10 Discussant: Chermela, Janet

[213] General Session: Cannibalism: Recognition and Analysis

Audubon B
 Chair: Rolett, Barry

Participants

- 4:10 Bullock, Peter; Meal or Murder? A Reappraisal of Anasazi Cannibalism.
 4:25 Rechtman, Robert; Archaeological Investigations on Wakaya Island, Fiji.
 4:35 Rolett, Barry; Cannibalism: New Archaeozoological Evidence From Polynesia.

[214] General Session: Quantitative Methods: Expert Systems, Sampling, and Geophysical Survey

Grand Ballroom Salon C
 Chair: Fotiadis, Michael

Participants

- 4:10 Johnson, Ian & Ian Turner; Managing on Scarce Resources: An "Expert" Approach to Wide-Area Predictive Modeling.
 4:25 Fotiadis, Michael; Chipped Stone in an Expert System: Theoretical Implications.
 4:40 Wright, William E; Tree-Ring Field Sampling Modification: Ensuring Optimum Datability.
 4:50 Sanchez, Julia & Brian S Shaffer; Biases of 1/4" and 1/8" Screening on Controlled Samples of Vertebrate Skeletons.
 5:05 Ellwood, Brooks B, Francis B Harrold & Anthony E Marks; Upper Paleolithic Site Exploration in Portugal and France Using Electrical Resistivity Surveys.
 5:20 Mizrachi, Yonathan; Geophysical Survey and Follow-Up Excavations at Rujm el-Hiri, a Third to Second Millennium BC Megalithic Site From the Golan Heights.

[215] General Session: Geoarchaeology from Forensics to Landscapes

Audubon A
 Chair: Schuldenrein, Joseph

Participants

- 4:10 Adovasio, J M, J Donahue & G A Cooke; Forensic Geoarchaeology: Three Case Studies.
 4:25 Keller, John; Clear Creek Bay: Stratigraphy and Lithic Analysis at a Coles Creek/Marksville Center.
 4:40 Mandel, Rolfe; Chronology and Geoarchaeology of the Stigenwalt Site, Southeastern Kansas.
 4:55 Schuldenrein, Joseph; Geoarchaeological Observations in West-Central Jordan.

[216] General Session: Computers, Statistics, Sampling, and Pattern Recognition

Mimosa
 Chair: Weiss, Andrew D

Participants

- 1:30 Stratton, Susan; Samples of Samples.
 1:45 Gordon, Elizabeth A; Differential Faunal Recovery and Models of Subsistence Change: A Hawaiian Example.
 1:55 Wilshusen, Richard; A Proposal for Studying Cultural Processes at the Regional Level.
 2:10 Weiss, Andrew & Loa Traxler; Computer-Assisted Analysis of Architectural Development at Copan.
 2:25 Banning, Edward; Hypermedia and the Publication of Archaeological Research Results.
 2:40 Farnsworth, Paul & L A Wilkie Farnsworth; South's Artifact Pattern Analysis: Retirement Beckons a Controversial Technique.

[217] Panel: Publishing: A Student's Guide

Mimosa
 Organizer & Chair: Hamilton, J Rachel

Panelists

- 3:45 Reid, J Jefferson
 Knight, Vernon J, Jr
 Brose, David S
 Rice, Prudence M
 Goodwin, Daniel
 King, Jaime Litvak

THURSDAY EVENING APRIL 25, 1991**[218] Plenary Session: Explanation in Archaeology Revisited: 1971-1991**

Tulane

Organizers: Redman, Charles L & Timothy A Kohler

Chair: Sabloff, Jeremy A

Participants

- 8:00 Sabloff, Jeremy A; Introduction.
 8:15 Redman, Charles L; The Social Context of New Archaeology: Then and Now.
 8:35 Watson, Patty Jo; Archaeological Explanation: Reactions and Rebuttals.
 8:55 LeBlanc, Steven; Archaeology as Big Science: Present and Future Prospects.
 9:15 Questions & Discussion.

FRIDAY MORNING APRIL 26, 1991**[301] Sponsored Workshop: Archaeological Science on Public Lands (ASCA Workshop)**

Mimosa

Organizer & Chair: Knudson, Ruthann

Discussion Leaders & Recorders

- 8:00 Larry Banks, Jerry Clarke
 Bennie Keel, Jon Czaplicki
 William D Lipe, Paul Gleeson
 Sue Ann Curtis, Lynn McDonald
 Leslie Wildesen, Paul Nickens

[302] Symposium: Food for Thought: CRM Research in California Should Place More Emphasis on Environmental and Subsistence Studies

Cypress

Organizer & Chair: de Barros, Philip

Participants

- 8:00 De Lanoise, Jeanne & Owen K Davis; Late Holocene Climatic Change in Coastal Southern California.
 8:20 Sutton, Mark Q; Late Prehistoric Environmental and Cultural Change in the Western Mojave Desert.
 8:40 Yohe, Robert M, II & Margaret Newman; Blood Residue Analysis: New Applications in the Study of Archaeological Assemblages.
 9:00 Cerreto, Richard; Marine Invertebrate Studies for the Southern California Coast.
 9:20 Miksicek, Charles; Beyond Acorns and Shellfish: The Potential for Archaeobotanical Analysis in California Archaeology.
 9:40 de Barros, Philip; Interpreting Late Prehistoric Settlement-Subsistence Patterns in the Newport Bay-San Joaquin Hills Area of Southern Coastal California.
 10:00 Discussant: Moratto, Michael

[303] Symposium: Production and Exchange in Southeast Asia Prehistory

Audubon A

Organizers & Chairs: Junker, Laura & Elisabeth Bacus

Participants

- 8:00 Mudar, Karen; Alternative Models for Development of Agricultural Systems in Mainland Southeast Asia: Settlement Pattern Data From Central Thailand.
 8:20 Bacus, Elisabeth; Decorated Earthenware Production and Exchange in Early Complex Societies in the Central Philippines.

- 8:40 Junker, Laura; Economic Specialization and Lowland-Upland Exchange in Late Prehistoric Philippine Chiefdoms.
 9:00 Nishimura, Masao; Long Distance Trade and the Development of Complex Societies in the Prehistory of the Central Philippines: The Example of the Cebu Settlement.
 9:20 Discussant: Hutterer, Karl

[304] Symposium: Mortuary Analysis on the Regional Level

Tulane

Organizer & Chair: Beck, Lane A

Participants

- 8:00 Brown, James; Where Has Mortuary Analysis Gotten Us?
 8:20 Charles, Douglas K; Diachronic Regional Social Dynamics: The Analysis of Mortuary Sites in West-Central Illinois.
 8:40 Goldstein, Lynne; Landscapes and Mortuary Practices: A Case for Regional Mortuary Perspectives.
 9:00 Bradley, Richard; Mortuary Ritual in Prehistoric Europe 1500-700 BC: Exploring the Regional Dimension.
 9:20 Chapman, Robert; Ten Years After: Megaliths, Mortuary Practices, and the Territorial Model.
 9:40 Griswold, William; The Use of Regional Mortuary Data to Assess the Role of Long-Distance Trade in Egyptian State Formation.
 10:00 Fisher, Genevieve; Kingdom and Community in Early Anglo-Saxon Eastern England.
 10:20 O'Shea, John M; Mortuary Custom in the Copper and Bronze Age of Eastern Hungary: Diachronic and Synchronic Approaches.
 10:40 Beck, Lane; Regional Cults and Ethnic Boundaries in "Southern Hopewell."
 11:00 Smith, Virginia G, George R Milner & Eve Anderson; Human Remains, Mortuary Context, and Intergroup Conflict.
 11:20 Buikstra, Jane, Lyle Konigsberg & Michael Conner; Genes, Bones, and Pots.
 11:40 Discussant: Binford, Lewis R

[305] General Session: Taphonomy and Site Formation Processes

Magnolia

Chair: Oliver, James S

Participants

- 8:00 Capaldo, Salvatore D; Hominids, Carnivores, and Dual-Patterned Archaeological Bone Assemblages.
 8:15 Oliver, James S; Bone Fracture Patterns and Damage Overprinting: Meat Acquisition by Hominids at FLK Zinjanthropus, Olduvai Gorge, Tanzania.
 8:30 Steele, D Gentry, Larry D Martin & Wakefield Dort; Human Remains From Bonner Springs, Kansas: A Late Pleistocene/Holocene Locality.
 8:45 McBrearty, Sally, Laura Bishop & Thomas Plummer; Nondeliberate Stone Artifact Retouch Resulting From Human Trampling at Replicated Archaeological Sites.
 8:55 Berman, Mary Jane & Perry L Gnivecki; Bahamian Prehistory: A Question of Parts or (W)Holes.
 9:10 McNair, Anna; Refuse Disposal Studies From Albion Island, Belize.

[306] Symposium: Evaluating Models of Early Paleoindian Foraging Behavior

Audubon E

Organizer & Chair: Tankersley, Kenneth B

Participants

- 8:00 Shott, Michael; Economy and Social Form Among Foragers: Great Lakes Paleoindian Examples.
 8:20 Ellis, Christopher & D Brian Deller; Investigations at a Small Early Paleoindian Site in Southwestern Ontario,

- 8:40 Freeman, Andrea K L & Edward E Smith; Archaeological Investigations of the Little River Paleoindian Site Complex, Christian County, Kentucky: The 1990 Field Season.
- 9:00 Morrow, Juliet; Potentialities for Subsurface Paleoindian Sites in the Lower Illinois Valley.
- 9:20 Seeman, Mark F; Intercluster Relationships at Nobles Pond: A Large, Early Paleoindian Site in Northeastern Ohio.
- 9:40 Munson, Patrick J & Kenneth B Tankersley; Early Paleoindian Settlement of the Grand Prairie.
- 10:00 Tankersley, Kenneth B & Michael Wiant; The Bostrom Site: An Early Paleoindian Workshop-Habitation in Southwestern Illinois.
- 10:20 Wiant, Michael & Howard D Winters; The Lincoln Hills Sites: A Paleoindian Workshop in the Central Mississippi Valley.
- 10:40 Kay, Marvin & Russel W Graham; Kimmswick: A Taphonomic View of Midwestern Clovis Foraging and Technology.
- 11:00 Saunders, Jeffrey, Edward Daeschler & Beth Dawson-Saunders; An Engraved Mammoth Bone From Blackwater Draw Locality No. 1, New Mexico.
- 11:20 Gramly, Richard M; Concluding Excavations at the East Wenatchee Clovis Site (Richey-Roberts Site), Douglas County, Central Washington.
- 11:40 Discussant: Dincauze, Dena F

[307] Symposium: The Public Interpretation of Archeological Sites: Problems and Issues

Audubon B
Organizer & Chair: Jameson, John H, Jr

Participants

- 8:00 Robinson, Rory L; Bringing Archaeology out of the Closet.
- 8:20 Hoffman, Teresa L; The Role of Public Participation in Protecting, Promoting and Interpreting Cultural Resources.
- 8:40 Gelburd, Diane & Michael J Kaczor; A Strategy for Developing Successful Public Education and Interpretation Programs.
- 9:00 Hughes-Jones, A Alicia; Public Interpretation of Archaeological Sites Through Hands-On Experience.
- 9:20 Hughes, David T; Conflicts and Resolutions: Public Archaeology and Private Funds.
- 9:40 Honerkamp, Nick & Martha Zierden; The Evolution of Interpretation at the Charleston Place Site.
- 10:00 Vrabel, Deborah; Stories of the Past: Comparisons From Great Britain.
- 10:20 Kirkorian, Cece, Robert Ewing & Betsy Kearns; Interpreting and Preserving Rock Shelters for Rock Climbers.
- 10:40 Gleeson, Paul & Teresa Shirakawa; Compliance Archaeology and Interpretation in Alaska.
- 11:00 Joseph, J; Making the Past Public From a National Perspective: The Public Archaeology of the French Paleolithic and the Urban US.
- 11:20 Jameson, John H, Jr; Sharpening the Focus: Reactions and Revelations From the 1990 National Interpreters Workshop.
- 11:40 Discussants: Rippeteau, Bruce & Michael Trinkley

[308] Symposium: Organization and Technology of Prehispanic Ceramic Production in the Andes

Audubon C
Organizer: Shimada, Izumi
Chair: Raymond, Scott

Participants

- 8:00 Raymond, J Scott, Augusto Oyuela & Patrick Carmichael; A Comparison of the Earliest Ceramic Technologies of Ecuador and Colombia.
- 8:20 Rostoker, Arthur, James H Burton & Karen Olsen Bruhns; Red Banded Incised: Evidence for Highland-Lowland Exchange in Late Formative Ecuador.
- 8:40 Shimada, Izumi, Carlos G Elera & Victor Chang; Cupisnique Ceramic Kilns and Production: Excavation and Experimental Data.

- 9:00 Wagner, Ursel; Firing Conditions and Compositional Characteristics of Formative Ceramics: Archaeometric Perspective.
- 9:20 Cummins, Tom; The Figurine Tradition of Coastal Ecuador: Technological Styles.
- 9:40 Russell, Glenn S & L Leonard Banks; Moche IV Specialized Ceramic Production: The Mocollope Workshop, Chicama Valley, Peru.
- 10:00 Cleland, Kathryn & Izumi Shimada; Technology, Social Organization, and Chronology of Sican *Paiteada* Ceramic Production.
- 10:20 Hayashida, Frances; The Organization of Pottery Production During Inka Rule: A Case Study From the North Coast of Peru.
- 10:40 D'Altroy, Terence, Ana Maria Lorandi & Veronica Williams; Ceramic Production and Use in the Inka Political Economy.
- 11:00 Costin, Cathy L & Melissa B Hagstrum; Standardization, Labor Investment and the Organization of Production in Late Prehispanic Highland Peru.
- 11:20 Discussants: Lyon, Patricia & Prudence Rice

[309] Symposium: The Social Dynamics of Goods and Information: Archaeological Perspectives

Grand Ballroom Salon B
Organizers & Chairs: Hegmon, Michelle & Patricia Wattenmaker

Participants

- 8:00 Jones, Karin & Michelle Hegmon; The Medium and the Message: A Survey of Information Conveyed by Material Culture in Middle-Range Societies.
- 8:20 White, Randall; Sungir: The Material Construction of Social Identity in the Early Upper Paleolithic.
- 8:40 Hays, Kelley Ann; Social Contexts of Style and Information in a 7th Century Basketmaker Community.
- 9:00 Tainter, Joseph A & Bonnie Bagley Tainter; The Towers of Hovenweep.
- 9:20 Dunham, Gary; Ambiguous Information: The Emergence of Burial Mound Ritual in Late Prehistoric Central Virginia.
- 9:40 Berman, Judith C; Ceramic Production, Style, and Information in 5th Millennium Mesopotamia.
- 10:00 Thuesen, Ingolf; Northern Ubaid Ceramic Design: Symbolism and Function.
- 10:20 Stein, Gil; Imported Ideologies and Local Identities: A Comparison of North and South Mesopotamia in the 6th to 5th Millennia BC.
- 10:40 Wattenmaker, Patricia; Specialization, Standardization, and the Symbolic Role of Goods in Complex Societies.
- 11:00 Stanish, Charles; Burial Style and Elite Communication Systems in the Central Andes.
- 11:20 Discussants: Conkey, Margaret & H Martin Wobst

[310] Symposium: Assessing the Research Potential of Large, Damaged Sites in the American Southwest

Audubon D
Organizer & Chair: Ahlstrom, Richard

Participants

- 8:00 Ahlstrom, Richard V N, Malcolm H Adair & R Thomas Enler; The Research Potential of Vandalized Sites on Perry Mesa, Central Arizona.
- 8:20 Adams, E Charles; Pueblos, Pots, and Pot Hunters: Research at Homol'ovi, a Severely Vandalized Pueblo in the American Southwest.
- 8:40 Scheick, Cherie; The Agua Fria Schoolhouse Site: A Contemporary Caution.
- 9:00 Greenwald, David H & Mark L Chenault; Differentiating the Effects of Urbanization, Alluviation, and Time on Hohokam Sites in the Phoenix Basin.
- 9:20 Breternitz, Cory Dale, Michael S Foster & Christine K Robinson; Opportunities, Limitations, and Hazards: Making the Most of Large Site Archaeology and Urban Freeway Corridors in the Phoenix Basin.
- 9:40 BREAK
- 10:00 Reid, J Jefferson & Stephanie M Whittlesey; Repairing the Record of Kinishba Pueblo, Arizona.

- 10:20 Hohmann, John W; Backdirt Bounty: The Research Potential of Previously Excavated Sites.
 10:40 Pillis, Peter J, Jr ; Elden Pueblo: The Frustrations of Following Fewkes.
 11:00 Discussants: Judge, W James & Steven A LeBlanc

[311] Symposium: Exploring and Exploding Myths About Cahokia

Grand Ballroom Salon A
 Organizer & Chair: Kelly, John E

Participants

- 8:00 Kelly, John; Myth-Conceptions About Cahokia's Urbane Character.
 8:20 Williams, Stephen; Nineteenth Century Perceptions of Cahokia and its Meaning.
 8:40 Emerson, Thomas E; Ramey Incised Symbolism in Cahokian and Regional Contexts.
 9:00 Lopinot, Neal; Plants and Cahokian Culture: Some Amazing Fables.
 9:20 Pauketat, Timothy R; The Crafty Elite of Cahokia: Redefining Mississippian "Specialization."
 9:40 Woods, William I & Christy L Wells; Up Cahokia Creek Without a Paddle?
 10:00 Milner, George R; Cahokia Area Settlements: Consensus and Controversies.
 10:20 Holley, George; Cahokia as a State?
 10:40 Finney, Fred & James B Stoltman; Cahokia and its Northern Hinterlands: The Migration Hypothesis Reconsidered.
 11:00 Griffin, James B; Cahokia and its Neighbors: Archaeological Myth-stakes.
 11:20 Discussants: Wright, Henry & Bruce D Smith

[312] General Session: Arctic and Subarctic

Audubon A
 Chair: Yesner, David

Participants

- 10:00 Yesner, David, Kristine J Crossen & Charles E Holmes; Late Pleistocene Subsistence and Paleoenvironments at the Broken Mammoth Site, Tanana Valley, Alaska.
 10:15 Saville, James; An Ethnoarchaeological Investigation of Inuit Beluga and Narwhal Harvesting.
 10:30 Cassell, Mark; Station Natives: Commercial Whaling, Eskimo Labor, and an Archaeology of Kelly's Station, North Alaska.
 10:45 Veltre, Douglas W, Allen P McCartney & Jean S Aigner; Early Russian Contact in the Eastern Aleutian Islands: A Report on Excavations at Reese Bay, Unalaska.
 11:00 Jackson, Louise; From Sherds to Vessels: Joining the Archaeological and Historical Records.

[313] Symposium: Evolutionary Approaches for Understanding Human Behavior Through the Use of Archaeological Research

Grand Ballroom Salon C
 Organizer & Chair: Kodack, Marc

Participants

- 8:20 Kodack, Marc; The Application of "Population Thinking" to Archaeological Research.
 8:40 O'Brien, Michael & Thomas D Holland; The Role of Adaptation in Archaeological Explanation.
 9:00 Hargrave, Michael; A Selectionist Perspective on Late Prehistoric Architectural Change in the Midwestern US.
 9:20 Zeanah, David W; Resource Transportation Costs and Optimal Site Location Strategies.
 9:40 Leonard, Robert D, Heidi E Reed & Roger Anyon; Population Aggregation and Labor Organization in the American Southwest.
 10:00 BREAK
 10:20 Patton, John Q & Herbert D G Maschner; Kin-Selection and the Rise of Hereditary Social Inequality: Archaeological Implications.

- 10:40 Jones, Kevin T & David B Madsen; Archaeology, Natural Selection and the Illusion of Culture.
 11:00 Discussants: Dunnell, Robert C & Robert Boyd

[314] General Session: Techniques for Spatial Analysis: New World

Magnolia
 Chair: Kvamme, Kenneth L

Participants

- 9:50 Polhemus, Richard R, Sarah C Sherwood & Jan F Simek; A Late Mississippian Household: Spatial Organization and Spatial Structure.
 10:05 Kvamme, Kenneth L & Daniel O Larson; Distributional Archaeology Through the Integration of Multiple Technologies: Examples From Projects in Utah and Colorado.
 10:20 Gould, Russell T; Prehistoric Cultural Geography and the Implication of Evolutionary Change: Mobility and Anadromous Fish Use Along the Middle Snake River, Southwestern Idaho.
 10:35 Baldwin, Anne & J Michael Bremer; Cultural Dynamics Along a Prehistoric Frontier: An Example From Deadmans Wash in Northern Arizona.
 10:50 Bettison, Cynthia; The Determinants of Settlement Patterns Among Prehistoric Agriculturalists in East-Central Arizona.
 11:05 Kralick, Kollen; Historical Archaeology in the Black Range of New Mexico: Isolated Settlements and Economic Frontiers.
 11:15 Gamble, Lynn; A Spatial Analysis of Pollen and Small Cultural Remains Recovered in a Clay Floor.
 11:30 Quattrin, Dale; The Haves, the Have-Nots, and the Household: Taking Blanton the Next Step.
 11:45 Alexander, Rani T; Late Colonial Period Community Organization in Yaxcaba Parish, Yucatan, Mexico.

[315] General Session: Physical Anthropology and Demography

Cypress
 Chair: Storey, Rebecca

Participants

- 10:30 Powell, Joseph F & D Gentry Steele; Medical Disorders in North American Late Pleistocene/Early Holocene Human Remains.
 10:45 Herrmann, Nicholas P; The Paleodemography of the Read Shell Midden.
 11:00 Hayward, Michele, Edwin Crespo Torres & Miguel Rodríguez López; Demographic Analysis of the Punta Candelero Skeletal Population.
 11:15 Storey, Rebecca; Bioarchaeology of El Cajon, Honduras.
 11:30 Jansen, Henrik M; Skeletons and Latrines: The Archaeology of Medieval Svendborg, Denmark.
 11:45 Kirkendall, Melissa & Terry L Hunt; The Archaeology of Population Collapse in the Yasawa Islands, Fiji.

[316] General Session: Posters: North American Research and Cultural Resource Management

Exhibition Hall

Participants

- Hoffman, Teresa L & Mary Briggs; Arizona's Site Stewards: Volunteers Protecting our Past.
- King, Thomas F & Francis P McManamon; Artifact Diggers, Collectors, and Dealers: What We Know and What We Don't Know.
- Grisafe, David A & Paul R Nickens; Chemical Stabilization of Porous Sandstones Bearing Petroglyphs.
- Hoard, Robert J, Steven R Holen & Michael Glascock; Neutron Activation Analysis of Flattop Chalcedony From Flattop Butte, Colorado, Nelson Butte/West Horse Creek South Dakota and the Eckles Site, North-Central Kansas.

- 5 Larson, Mary Lou; George C Frison & Eric E Ingbar; High Altitude Human Occupation at the Helen Lookingbill Site, Wyoming.
- 6 Bianchi, Thomas & Paul V Heinrich; Geoarchaeological Evidence of a Middle Holocene Pluvial Episode in the Kalamazoo River Valley of Southwestern Michigan.
- 7 Carr, H Sorayya; Bellcow Shelters, Oklahoma: Issues in the Ecological Interpretation of Archaeofaunal Remains.
- 8 Bowen, Jonathan E; Early Woodland Remains in the Western Flint Ridge Area, Ohio.
- 9 Raemisch, Carol & Susan Dauria; A Classification of Cutmarks: Skeletal Evidence for Defleshing and Dismemberment.
- 10 Dancey, William; Woodland Period Adaptive Systems in Central Ohio.
- 11 Wagner, Mark & Mary R McCorvie; The Archaeology of the "Old Landmark": An Early 19th-Century Frontier Tavern on the St. Louis-Vincennes Trace of Southern Illinois.
- 12 Haywood, Norman A & Michael R Waters; Geomorphic Setting of Archaeological Sites Along the Central Portion of the Brazos River Valley, Texas.
- 13 Rogers, Anne; Early European Trade Items as Indicators of Settlement Patterns in Western North Carolina.

FRIDAY NOON APRIL 26, 1991

[401] Roundtable: Luncheon for Women Graduate Students and Pre-Professionals in Archaeology

Mimosa [Preregistration & Fee Required]

Organizers: Conkey, Margaret, Christine A Hastorf & Margaret Nelson

Opening Remarks

- 12:00 Gero, Joan M; Issues and Implications of the Sociopolitics of Archaeology.

Roundtables

Knudson, Ruthann; Issues in Considering Federal/Private Employment.
 Hastorf, Christine A & Ruth Tringham; Issues in Undertaking Fieldwork Outside North America.
 Watson, Patty Jo; Issues in Publishing: Where and How to Publish.
 Kramer, Carol; Issues in Getting Grants and the Research Process.
 Nelson, Margaret C; Fieldwork, Families, and Careers.
 Stein, Julie & Joan M Gero; The Academic Career: Options, Tracks, and Tenure.
 Wylie, Alison; Issues in the Workplace: The "Chilly Climate" for Women—as Students, as Leaders, as Professionals.
 Dincauze, Dena F & Margaret Conkey; Issues in the Job Market: Resumes, Experience, Interviews.

FRIDAY AFTERNOON APRIL 26, 1991

[402] Roundtable: Writing for the Public

Mimosa

Organizer & Chair: Young, Peter A

Panelists

- 3:00 Young, Peter A
 Fagan, Brian
 Gibbons, Ann (invited)

[403] Poster Symposium: Method in the Madness: Capturing and Assessing Variation in the Archaeological Record Via Exploratory Data Analysis

Exhibition Hall

Organizer & Chair: Hawkins, R A

Participants

- 1 Hawkins, Rebecca A; A Rim Diameter Analysis of Fort Ancient Ceramics From the Horseshoe Johnson Village.
- 2 Hartman, Patricia J & Rebecca A Hawkins; Analysis of the Ceramics From the Stratified Middle Woodland Twin Mounds Village.
- 3 Trader, Patrick D; Systematic Surface and Subsurface Investigations at a Newtown Phase Village in Northern Kentucky.
- 4 Pitner, Gavine N; Feature Assemblages and Debris Profiles at Owens Rockshelter.
- 5 Vickery, Kent D; Late Archaic Faunal Exploitation and Use in Southwestern Ohio.
- 6 Tolonen, Anthony S; Spatial Variation in the Horseshoe Johnson Lithic Assemblage.
- 7 Connolly, Robert P; Activity Patterning at Fort Ancient, a Middle Woodland Hilltop Enclosure.
- 8 Ross, Steven P & Anthony Tolonen; The Value of Plowzone Lithic Scatters in Understanding Late Archaic Land Use.

[404] Symposium: Settlement and Landscapes in Prehistoric Europe

Tulane

Organizer: Wells, Peter S

Chair: Bogucki, Peter

Participants

- 1:30 Malone, Caroline; Processes of Neolithic Colonization in the Central Mediterranean.
 1:50 Bogucki, Peter; Changing Neolithic Landscapes at Brzesc Kujawski, Poland.
 2:10 Stoddart, Simon; Trajectories in Bronze Age Settlement in the Central Mediterranean.
 2:30 Spivey, Nigel; Rural Settlement and State Formation in Central Italy.
 2:50 BREAK
 3:10 Sandberg, Curtis; Iron Age Settlement in Alpine Europe: Responses to Natural Constraints.
 3:30 Wells, Peter S; Site Selection Processes: Late Iron Age Kelheim.
 3:50? 4:10 Crumley, Carole; Landscape, Climate, and the Historical Ecology of Conquest.

[405] Symposium: Ceramic Paste Characterization: Methodology, Techniques, and Recent Applications

Audubon B

Organizer & Chair: Neff, Hector

Participants

- 1:30 Guerrero Miranda, Juan Vicente, Frederick W Lange & Veletta Canouts; The Greater Nicoya Ceramic Data Base.
 1:50 Hodge, Mary & Hector Neff; Neutron Activation in Stylistic and Spatial Analyses of Aztec Ceramics.
 2:10 Harbottle, Garman & Evelyn C Rattray; The Characterization of Mesoamerican "Thin Orange" by Neutron Activation Analysis.
 2:30 Whittlesey, Stephanie, Paul R Fish & Suzanne K Fish; Hohokam Classic Period Ceramic Production and Exchange in the Northern Tucson Basin, Southern Arizona.
 2:50 Clark, Caven; Neutron Activation Analysis of Late Woodland Ceramics From the Lake Superior Basin.
 3:10 Myers, Emlen; Compositional Investigations of Elite Glaze-Painted Ceramics of 16th-Century Italy.
 3:30 Zubrow, Ezra, Jay Leavitt & Shannon Fie; A Comparison of Pattern Recognition Techniques Using Philippines Ceramics.
 3:50 Stoltman, James B & James H Burton; Chemical and Petrographic Characterizations of Ceramic Pastes: Two Perspectives on a Single Data Set.
 4:10 Rands, Robert; Integrative Approaches in the Compositional Characterization of Ceramic Pastes.
 4:30 Elam, James, Michael D Glascock & Christopher Carr; Texture-Related Variation in the Chemical Composition of Pottery: Ultrasonic Disaggregation and INAA of Tucson Basin & Ohio Valley Ceramics.

- 4:50 Blackman, M James; The Effect of Natural and Human Size Sorting on the Mineralogy and Chemistry of Ceramic Clays.
 5:10 Discussant: Bishop, Ronald

[406] Symposium: The Organization of Ceramic Production in the American Southwest

Audubon A

Organizers & Chairs: Mills, Barbara J & Patricia L Crown

Participants

- 1:30 Walsh-Anduze, Mary-Ellen & David R Abbott; Reconciling Opposing Typologies: Multiple Manufacturing Traditions for Hohokam Redware Ceramics.
 1:50 Raveslout, John C; Preliminary Observations From Ceramic Paste Compositional Analyses of Rillito and Tanque Verde Red-on-Brown Pottery.
 2:10 Hegmon, Michelle, Winston Hurst & James R Allison; Production for Local Consumption and Exchange: Comparisons of Early Red and White Ware Ceramics in Southeast Utah.
 2:30 Wilson, C Dean & Eric Blinman; Changing Specialization of White Ware Manufacture in the Northern San Juan Region.
 2:50 Zedeno, Maria N; The Role of Population Movement and Technological Transfer in the Manufacture of Prehistoric Southwestern Ceramics.
 3:10 Woodman, James; Clay Procurement and the Organization of Pottery Production in the Late Prehistoric Southwest: Examples From Fourmile and Chavez Pass Ruins.
 3:30 Crown, Patricia L; The Production of the Salado Polychromes in the American Southwest.
 3:50 Habicht-Mauche, Judith A; Changing Patterns of Pottery Manufacture and Trade in the Northern Rio Grande During the 14th Century.
 4:10 Mills, Barbara J & James M Vint; Settlement Stability and the Organization of Late Prehistoric/Early Historic Ceramic Production in the Zuni Area.
 4:30 DeAtley, Suzanne, Veletta Canouts & Ronald Bishop; Modeling Changes in Technological Style and Organizational Structure of the Hopi Yellow Ware Tradition, AD 1300-1600.
 4:50 Discussants: Hagstrum, Melissa B & Stephen Plog

[407] Symposium: In Search of the Jama-Coaque Chiefdom: Interdisciplinary Perspectives on Regional Environment, Settlement Dynamics, and Agricultural Production in Northern Manabí Ecuador

Audubon C

Organizer: Pearsall, Deborah M

Chair: Zeidler, James A

Participants

- 1:50 Zeidler, James; Regional Archaeology in Northern Manabí (Ecuador): Sampling for Spatial Patterning.
 2:10 Kennedy, Robin & Deborah M Pearsall; Use of Present Vegetation Profiles and Agricultural Land-Use Patterns in Reconstruction of Past Environments.
 2:30 Donahue, Jack; Depositional and Erosional History of the Rio Jama Drainage as Related to Prehistoric Occupation.
 2:50 Isaacson, John; The Pululagna Tephra Fallout and the End of the Formative Period in Northwestern Ecuador: Views From the Highlands, Montana and Coast.
 3:10 Sutliff, Marie & James A Zeidler; A Ceramic Sequence for the "Jama-Coaque" Occupation of the Jama River Valley, Northern Manabí, Ecuador.
 3:30 Wolford, J A; Stone Tool Dynamics: Lithic Industries in the Jama River Valley, North Coastal Ecuador.
 3:50 Stahl, Peter; Archaeological Recovery of Neotropical Faunas From the Jama River Drainage, Manabí, Ecuador.
 4:10 Zimmerman, Laurie & Vaughn M Bryant Jr; Pollen Studies of Manabí Province, Ecuador.
 4:30 Pearsall, Deborah M; Prehistoric Subsistence and Agricultural Evolution in the Jama River Valley, Manabí Province, Ecuador.
 4:50 Discussant: Drennan, Robert D

[408] Symposium: Social Forms and Linkages Producing Andean Monumentalism

Audubon D

Organizers & Chairs: Dillehay, Tom & Richard Burger

Participants

- 1:30 Drennan, Robert D; San Agustín Monuments in Social Context.
 1:50 DeBoer, Warren; Mini-Monumentalism: The Case of the Chachi Ceremonial Center.
 2:10 Doyon, Leon; The Pit and the Pyramid: Burial Traditions and the Development of Monumentalism in the Northern Andes of Ecuador.
 2:30 Topic, Teresa Lange & John R Topic; The Meaning of Monumentality at Marcahuamachuco.
 2:50 Pozorski, Thomas & Sheila Pozorski; Economic Variables Affecting Emerging Monumentalism on the North-Central Coast of Peru.
 3:10 BREAK
 3:30 Burger, Richard; Socioeconomic Basis for Monumental Architecture During Peru's Initial Period.
 3:50 Kolata, Alan; Sacred Mountain, Island Enceinte: Cosmogony and the Reproduction of Tiwanaku Urban Form.
 4:10 Dillehay, Thomas D; Araucanian Ceremonial Transformations Produced by Rotating Ritual Audiences.
 4:30 Discussants: Patterson, Thomas C & Henry Wright

[409] Symposium: Approaches to Mississippi Period Political Economy in the Southeastern United States

Grand Ballroom Salon B

Organizers & Chairs: Cobb, Charles R & Jon Muller

Participants

- 1:30 House, John H; Mississippian Settlement and Mississippian Dynamics in the Lower St Francis Basin, Eastern Arkansas.
 1:50 Pertulla, Timothy K; The Development of Agricultural Economies in the Caddoan Area of the Trans-Mississippi South.
 2:10 Anderson, David G, David W Stahle & Malcolm K Cleaveland; Paleoclimates and Prehistoric Mississippian Economic Systems: Linking Archaeological and Dendrochronological Data in Southeastern Woodlands.
 2:30 Hatch, James W, Wayne C Boyko & Mary Theresa Bonhage-Sreund; Economic Trends During the Lamar Period: A View From the Upland Farmsteads of the Oconee Valley, Georgia.
 2:50 Scarry, John F; Apalachee Political Economy: Speculations and Evidence on External Connections and Internal Organization.
 3:10 Lewis, Barry; Mississippi Gulf Coast Economic and Interregional Exchange Patterns: AD 100-1750.
 3:30 Steponaitis, Vincas P; Production, Exchange, and Political Development in Two Mississippian Chiefdoms.
 3:50 Muller, Jon; Mississippian Political Economy and Production
 4:10 Welch, Paul D; Monopolistic Control Over Goods and the Political Stability of the Moundville Chiefdom.
 4:30 Cobb, Charles R; Relations of Production at the Mill Creek Chert Quarries and Workshops in Southern Illinois.
 4:50 Kreisa, Paul P; The Organization of Mississippian Political Economies of Western Kentucky.
 5:10 Nass, John P, Jr & Richard W Yerkes; The Role of Economy in the Emergence of Cahokia Mississippian and Ohio Fort Ancient Societies.

[410] Symposium: Courses Toward Social Complexity

Audubon E

Redman, Charles L & Kathryn E Pedrick

Participants

- 1:30 Redman, Charles L & Kathryn E Pedrick; Pursuing Southwestern Social Complexity in the 1990's.
- 1:50 Rice, Glen E; Examining the Issue of Complexity in the Sonoran Desert of Arizona.
- 2:10 Lindauer, Owen; Centralized Storage: Evidence From a Salado Platform Mound.
- 2:30 Jacobs, David F; Increasing Ceremonial Secrecy at a Salado Platform Mound.
- 2:50 Simon, Arley W, Jean-Christophe Komorowski & James H Burton; Patterns of Production and Distribution of Salado Wares as a Measure of Social Complexity.
- 3:10 Griffith, Carol A, Keith W Kintigh & Mary S Carroll; The Inference of Social Complexity From Distributions of Exotic Artifacts in the Tonto Basin.
- 3:30 Discussant: Hantman, Jeffrey

[411] Symposium: Where No Flake Has Gone Before: Applications of the Analysis of Lithic Debris to Interpreting Socioeconomic Relationships in Prehistoric Mesoamerica

Grand Ballroom Salon C

Organizers & Chairs: Hester, Thomas R & Marilyn A Masson

Participants

- 1:30 Mock, Shirley; The Late Terminal Classic Occupation at the Northern River Lagoon Site: A Functional Analysis of Lithic Debitage.
- 1:50 King, Eleanor; Tool Kits as Indicators of Late Classic Household Variation at Colha, Belize.
- 2:10 Masson, Marilyn A; Craft Specialist Cooperation and Autonomy: An Examination of Late Classic Lithic Workshop Composition at Colha, Belize.
- 2:30 McAnany, Patricia A; A Closer Look at the Producer-Consumer Model for Northern Belize.
- 2:50 Pope, Cynthia L; Lithic Debitage From Specialized Shell Working Tools at the Midway and Mosquito Groups at Caracol, Belize.
- 3:10 Cross, John R; Specialized Production, Distribution, and Consumption of Stone Tools at a Late Preclassic Workshop at Kichpanha, Northern Belize.
- 3:30 Dockall, John; Assemblage Variability of Oval Bifaces During the Mayan Late Preclassic: Production Versus Consumption.
- 3:50 Harris, John; Examining the Development of Craft Specialization Through Flake Aggregate Analysis.
- 4:10 Iceland, Harry; Obsidian Trade at the Close of the Classic Period in Central Mexico: The Evidence of the INAH Salvage Archaeology Excavations at Azcapotzalco, Mexico.
- 4:30 McSwain, Rebecca; The Application of Lithic Debitage Data to Socioeconomic Questions: Flakes and Exchange at Cuello, Belize.
- 4:50 Hester, Thomas R; The Impact of Debitage Studies in Maya Archaeology.
- 5:10 Discussant: Shafer, Harry J

[412] Symposium: Archaeological Currents Along the California Coast

Cypress

Organizer & Chair: Jones, Terry L

Participants

- 1:30 Jones, Terry L; Marine Resource Value and Coastal Settlement Priority: A California Perspective.
- 1:50 Hildebrandt, William R; Prehistoric Impact on the Structure of Marine Mammal Resources.
- 2:10 Lightfoot, Kent G; Coastal Hunter-Gatherers in the North Coast Ranges, California.
- 2:30 Simons, Dwight D; Prehistoric Exploitation of Mammals Around San Francisco Bay.
- 2:50 Glassow, Michael A; The Relative Dietary Importance of Marine Foods Through the Prehistory of the Vandenberg Region.
- 3:10 Raab, L Mark & Andrew Yatsko; Ancient Maritime Adaptations of the California Bight: A Perspective From San Clemente Island.
- 3:30 Salls, Roy A; The Application of Environmental Systems Theory for Modeling Subsistence Change on the Southern California Bight.

- 3:50 Gross, Timothy G; Site Formation and Transformation Processes in Coastal Shell Middens and Shell-Rich Sites.
- 4:10 Gallegos, Dennis; Coastal Settlement in San Diego County From 9000 to 1300 BP.
- 4:30 Christenson, Lynne E; A Settlement and Subsistence System for the Late Prehistoric People of San Diego County.
- 4:50 Discussants: Erlandson, Jon & David Yesner

[413] Sponsored Symposium: Fryxell Symposium 1991: Current Topics in Archaeozoology

Grand Ballroom Salon A

Organizer & Chair: Styles, Bonnie

Participants

- 1:30 McMillan, Bruce & Paul W Parmalee; A Pioneer in Zooarchaeology.
- 1:50 Styles, Bonnie & James R Purdue; The Marriage of Zoology and Anthropology: The Troubled Consummation of an Idea.
- 2:10 Snyder, Lynn M, Alison Galloway & P Willey; Bone Density Measures and Survival of Human and Nonhuman Skeletal Remains in Archaeological Contexts.
- 2:30 Kreutzer, Lee Ann; Explaining Bone Counts: Bison Bone Material Properties As Predictors of Skeletal Part Survivorship.
- 2:50 Reitz, Elizabeth; The Wells of St. Augustine.
- 3:10 BREAK
- 3:30 Klippel, Walter E & Robin Burgess; Faunal and Geologic Evidence for Environmental Change at Cheek Bend Cave, Tennessee.
- 3:50 Grayson, Donald K; Prevalence and Village Faunas From the Alpine Great Basin.
- 4:10 Lyman, R Lee; Prehistoric Seal and Sea Lion Transport and Butchering on the Southern Northwest Coast.
- 4:30 Wing, Elizabeth S; The Realm Between Wild and Domestic.
- 4:50 Discussant: Parmalee, Paul

[414] General Session: Researching Social and Political Organization in North America and Mesoamerica

Magnolia

Chair: Hammond, Norman

Participants

- 1:30 Huber, Edgar K; Site Size Differences and Community Organization in 13th-Century Pueblo Sites of the Northern Southwest.
- 1:45 Sneed, James E; Trails in the Eastern Anasazi Landscape: Data From the Pajarito Plateau.
- 2:00 Haynes-Peterson, Robert G; Interaction and Specialization at a Snaketown Satellite: Interpretations From the Lithic Assemblage at AZ:U:13:5, Arizona.
- 2:10 Ciolek-Torrello, Richard; Changing Household Structure in Two Prehistoric Southwestern Communities.
- 2:25 Stephens, Jeanette; Spatial Constraints on Social Interaction: A Processual Approach to the Study of Social Process.
- 2:40 McGowan, Kevin; Down-the-Line Interaction in the Shelbyville Locality.
- 2:50 Whittington, Stephen & Scott Zeleznik; History and Functions of a Pair of Neighboring Rural Elite Residential Compounds in the Ostuman Pocket, Copan, Honduras.
- 3:05 Kardatzke, Tim; Testing for a Ceremonial Cargo Cult Kitchen in Copan, Honduras.
- 3:20 Zeitlin, Judith Francis; Pre-Columbian Barrio Organization in Tehuantepec, Mexico and Colonial Period Transformations: Archaeological and Ethnohistoric Inferences.
- 3:30 Jamison, Thomas, Richard M Leventhal & Robin Robertson; Maya Sociopolitical Organization: The Study of Uxbenka, an Outlying Center.
- 3:45 Hammond, Norman, Amanda Clarke & Cynthia Robin; Middle Preclassic Burials at Cuello, Belize.
- 3:55 Wurtzburg, Susan; Domestic Architecture at Sayil, Mexico: Implications for Urban Organization.
- 4:10 Demarest, Arthur, Nicholas Dunning & Stephen Houston; Warfare, Ecology, and the Collapse of Classic Maya Civilization: New Perspectives From the Petexbatun Region.

- 4:25 Pendergast, David M; Trade and Elite Life From the 10th to the 13th Century at Marco Gonzalez, Belize.
- 4:35 Joyce, Rosemary; Innovation, Communication and the Archaeological Record: A Reassessment of Middle Formative Honduras.
- 4:50 Schortman, Edward & Patricia A Urban; Production and Political Power: The Political Economy of the Late Classic La Sierra Polity.

[415] General Session: Midwest and Great Lakes

Audubon E
Chair: Collins, James

Participants

- 4:05 Stafford, C Russell & Mark Cantin; Archaic Foraging Strategies: A Large-Scale Data Set From Southwestern Indiana.
- 4:20 Malinowski, Lynn M & Douglas Kullen; The Photon Site: An Archaic Settlement in the Forested Uplands of Northern Illinois.
- 4:30 Church, Flora; A Terminal Middle Woodland/Early Late Woodland Site in Muskingum County, Ohio: Preliminary Results From the Hunter 1 Site.
- 4:40 Collins, James M & Dale R Henning; The Bonaker Phase: Something Completely Different 40 Miles From the Florescence of Cahokia.
- 4:55 Gallagher, James P, Roland L Rodell & Randall M Withrow; The Oneota Orr Phase and the 17th-Century Ioway.

SATURDAY MORNING APRIL 27, 1991

[501] Symposium: The Transition to Agriculture: Old World

Tulane
Organizer & Chair: Gebauer, Anne Birgitte

Participants

- 8:20 Bar-Yosef, Ofer & Anna Belfer-Cohen; From Foraging to Farming in the Mediterranean Levant.
- 8:40 Byrd, Brian; Shifting Subsistence Strategies: The Onset of Agriculture in the Eastern Levant.
- 9:00 Close, Angela E & Fred Wendorf; The Beginning of Food-Production in Northeastern Africa.
- 9:20 Donahue, Randolph E; Desperately Seeking Ceres: A Critical Examination of Current Models for the Transition to Agriculture in Mediterranean Europe.
- 9:40 Keeley, Lawrence; The Introduction of Agriculture to the Western European Plain.
- 10:00 BREAK
- 10:20 Price, T Douglas & Anne Birgitte Gebauer; Last Hunters-First Farmers: Causes and Consequences in Northern Europe.
- 10:40 Woodman, Peter; Neolithic Beginnings in Ireland: The Case for Group Therapy.
- 11:00 Crawford, Gary; The Transition to Agriculture in East Asia.
- 11:20 Discussant: Speth, John D

[502] Symposium: Incidents of Excavation in Central America, Chiapas, and Yucatan: 150 Years of Maya Archaeology

Grand Ballroom Salon C
Organizer & Chair: Walker, Debra S

Participants

- 8:00 Stuart, George; John Lloyd Stephens: An Overview.
- 8:20 Fash, William & Ricardo Agurcia; Stephens' Predictions and our Predicament: Challenges of Historical Reconstruction and Conservation at Copan, Honduras.
- 8:40 Ashmore, Wendy; Of Catherwood and Cauac Sky: Changing Views of Quirigua.

- 9:00 Robinson, Eugenie; Iximche: A Capital of Two Cultures in Highland Guatemala.
- 9:20 Weeks, John M; John L Stephens and the Highland Maya Site of Utatlan, El Quiche, Guatemala.
- 9:40 Ayala, Maricela; Stephens and Catherwood at Tonina.
- 10:00 BREAK
- 10:20 Mathews, Peter; Stephens and Catherwood at Palenque.
- 10:40 Barrera, Alfredo; Uxmal: Past and Present of a Maya Site.
- 11:00 Freidel, David A & Ruth Krochock; Writing in the Dark: Chichen Itza and the Epigraphic Revolution.
- 11:20 Andrews, Anthony; Stephens and Catherwood on the Maya Coast: A Commentary.
- 11:40 Discussant: Sullivan, Paul

[503] Symposium: The Archaeology of Urbanism at Harappa, Pakistan

Audubon B
Organizers: Meadow, Richard & George Dales
Chair: George Dales

Participants

- 8:00 Possehl, Gregory & George Dales; The Harappa Project in Historical and Regional Perspective.
- 8:20 Hemphill, Brian & J R Lukacs; Adaptations and Affinities of Ancient Harappans.
- 8:40 Dales, George; The Significance of Ceramic Studies at Harappa.
- 9:00 Wright, Rita; Patterns of Technology in Harappan Ceramics.
- 9:20 Amundson, Ronald & Elise Pendall; Pedological Studies at Harappa, Pakistan.
- 9:40 Kenoyer, Jonathon M; Urban Process in the Indus Tradition: A Preliminary Model From Harappa.
- 10:00 Meadow, Richard; Faunal Remains and Urbanism at Harappa.
- 10:20 Belcher, William; Fish Resources in an Early Urban Context at Harappa, Pakistan.
- 10:40 Miller, Heather M-L; Agricultural Provisioning at Harappa.
- 11:00 Reddy, Seetha; Late Harappan Subsistence: An Example From Oriyo Timbo.
- 11:20 Discussants: Shaffer, Jim & Gregory Possehl

[504] Symposium: Nutritional Modeling in Archaeological Context

Audubon E
Organizer & Chair: Ezzo, Joseph A

Participants

- 8:00 Rapson, David & Lawrence C Todd; Body Parts, Processing Options, and Energy Sources: Contextual Interpretations of Archaeological Faunal Assemblages.
- 8:20 Sobolik, Kristin D; Paleonutrition of the Lower Pecos Region of the Chihuahuan Desert.
- 8:40 Ezzo, Joseph; The Dietary and Nutritional Dimensions of Stress at Grasshopper Pueblo, Arizona.
- 9:00 Hutchinson, Dale L & Lynette Norr; Corn and Dietary Importance: A View From Gulf Coast Florida.
- 9:20 Harn, Dawn E & Clark Spencer Larsen; Nutritional Implications of Infectious Disease in Precontact and Contact Era Populations From Northern Spanish Florida.
- 9:40 Schoeninger, Margaret; Interpreting Stable Isotope Results.

[505] Symposium: From Egalitarian to Authoritarian: the Evolution of Social Inequality in the Andes

Audubon A
Organizer & Chair: Malpass, Michael A

Participants

- 8:00 Aldenderfer, Mark; Ritual and the Emergence of "Accumulators" at Late Pre-ceramic Asana.
- 8:20 Rivera, Mario; Pre-Tiwanaku Developments in Northern Chile.

- 8:40 Goldstein, Paul S; Ceremonial Architecture, Status Differentiation and Provincial Power in the Tiwanaku Periphery.
 9:00 Pozorski, Shelia & Thomas Pozorski; Initial Period Social Inequality in the Casma Valley, Peru.
 9:20 Wilson, David J; Assessing the Rise of Sociopolitical Complexity in the Early Casma Valley Sequence.
 9:40 Stothert, Karen; From Equalitarian to Authoritarian: The Evolution of Social Inequalities in Prehistoric Coastal Ecuador.
 10:00 Lippi, Ronald D; Social Inequality in Northern Ecuador's Western Rainforest.
 10:20 Discussant: Moseley, Michael

[506] Symposium: An Archaeological Perspective on Geophysical Prospection, Or When Not to Dig

Audubon D

Organizers & Chairs: Weymouth, John & Rinita Dalan

Participants

- 8:20 Clay, R Berle; Earth Conductivity in Remote Sensing: Technology and Results.
 8:40 Dalan, Rinita; Expanding the Use of Geophysics in Archaeology: Macro and Micro Approaches.
 9:00 Orr, David; The Discovery of the Widow Tapp's House: Geophysical Survey of Ephemeral Historic Sites.
 9:20 Dobbs, Clark; The Application of Remote Sensing Techniques for Settlement Pattern Analysis at the Red Wing Locality.
 9:40 Roosevelt, Anna C; Investigation of Community Organization by Geophysical Survey.
 10:00 BREAK
 10:20 Lynott, Mark & James E Price; Geophysical Survey Methods Employed at the Shawnee Creek Site, Shannon County, Missouri.
 10:40 Thomas, David Hurst; On Theory Building in Noninvasive Archaeology.
 11:00 Discussants: Peebles, Christopher, Robert C Dunnell & John Weymouth

[507] Symposium: Continuity and Diversity: The Development of Regional Traditions in Americanist Archaeology (Fourth Symposium on the History of Archaeology)

Grand Ballroom Salon B

Organizers: Bender, Susan J & Christopher Downum

Chair: Downum, Christopher

Participants

- 8:00 Bender, Susan J & Edward V Curtin; Two Visions of New York State Prehistory.
 8:20 Danien, Elin & Eleanor M King; The University Museum at Piedras Negras: The Shift From Individual to Institutional Expeditions in Mesoamerica.
 8:40 McVicker, Donald E; Regional Archaeologies: Mayanists vs Mexicanists.
 9:00 Arnold, Philip; Cultural Ecology in the Basin of Mexico: A Historical Perspective.
 9:20 Roper, Donna C; The Perceived Role of the Horse and the Course of Archaeological Research on the Plains.
 9:40 Graves, Michael; The Study of Prehistoric Puebloan Pottery Designs: The Intellectual Tradition of Southwestern Archaeology.
 10:00 Fowler, Don D; Past and Present Others in Southwestern Anthropology.
 10:20 Jackson, Lawrence J & Paul T Thacker; Amateurs and the Development of Regional Archaeological Traditions: The Folsom, New Mexico Example.
 10:40 Pool, Kelly; A History of Amateur Archaeological Work in the St. Louis Area: 1940 to 1990.
 11:00 Givens, Douglas; Carl Chapman and Missouri Archaeology.
 11:20 Lyon, Edwin; The "Old Archaeology" as Anthropology: New Deal Archaeology in the Southeast.
 11:40 Discussants: Hinsley, Curtis M

[508] General Session: Plains and Rocky Mountains

Audubon A

Chair: Miller, Mark E

Participants

- 11:00 Gilmore, Kevin; Implications for Paleoclimatic Reconstruction and Site Formation Processes Based on Eolian Geochronology at the Bayou Gulch Site, Colorado.
 11:15 Bamforth, Douglas; Raw Material Use and Paleoindian Social Group Size on the Great Plains.
 11:30 Martinez, Valentina; An Analysis of Folsom and Midland Points From Several Sites in the Southern High Plains.
 11:45 Miller, Mark E & Dale L Wedel; Material Evidence for Multiple Use at Fort Fred. Steele, Wyoming, 1868-1940.

[509] Symposium: Recent Efforts in Archeological Site Protection

Cypress

Organizers & Chairs: Schneider, Kent A & Martin McAllister

Participants

- 8:20 Neumann, Loretta & Kent A Schneider; ARPA: Where From and Where To, an Overview.
 8:40 Johnston, Jim; ISHI: Archaeological Resources Protection Act Enforcement Project.
 9:00 Bass, Quentin, Norman Jefferson & Guy Blackwell; The Looting of a Protohistoric Cherokee Burial Cave.
 9:20 Des Jean, Tom; Archeological Resources Protection Act Violations Assessments: Variations on a Theme.
 9:40 Munson, Cheryl & David Pollack; From ARPA to ZILCH: Protection of Archaeological Sites on Private Lands.
 10:00 BREAK
 10:20 Osborn, Jill A, Tim Preso & Jeffrey J Kent; Artifact Looting Cases in Central Oregon: The Professional, Legal, and Social Ramifications.
 10:40 McAllister, Martin, Sherry Hutt & Elwood W Jones; Recent Trends in Archaeological Resource Protection.
 11:00 Jones, Elwood W & Martin McAllister; The Archaeological Resources Protection Training Program of the Federal Law Enforcement Training Center.
 11:20 Waldbauer, Richard; Protection Program Management Training.
 11:40 Discussants: Cleere, Henry F

[510] Symposium: Hunting by Farmers in the Prehistoric Southwest

Grand Ballroom Salon A

Organizers & Chairs: Spielmann, Katherine & Christine Szuter

Participants

- 8:20 Neusius, Sarah; Seasonality and Game Procurement Among the Dolores Anasazi.
 8:40 Sharp, Nancy D; Agricultural Site Selection and Faunal Resource Availability in Central Utah: Optimal Conditions in "Marginal" Locations.
 9:00 Szuter, Christine; Community Organization, Households, and Animal Procurement in the American Southwest.
 9:20 Bayham, Frank E & Antoinette Martinez; Artiodactyl Bone Element Patterning at Ventana Cave.
 9:40 Cameron, Judi; Artiodactyl Exploitation by Prehistoric Horticulturalists in the Lake Roosevelt Area, Arizona.
 10:00 BREAK
 10:20 James, Steven R; Hunting Patterns and Resource Depletion in Chiefdoms: A View From Hohokam Society in the American Southwest.
 10:40 Spielmann, Katherine; Protein Acquisition in the American Southwest.
 11:00 Eshbaugh, David C; Aboriginal Butchering Practices at Two Salinas (New Mexico) Pueblos: Toward the Reconstruction of Prehistoric Subsistence Practices.
 11:20 Potter, James; Differential Patterns of Fragmentation and Burning of Artiodactyl Elements From Two Anasazi Pueblo IV Sites.
 11:40 Discussant: Cruz-Urbe, Kathryn

[511] Sponsored Symposium: Professional/Avocational Interaction: The Role of the Individual and Local/State/Regional Organizations in the Furtherance of Archaeological Objectives

Audubon C

Organizer & Chair: Hohmann, William D

Participants

- 8:00 Lubensky, Earl H; Historical Development of Professional/Avocational Interaction as a Concern of the Society for American Archaeology.
- 8:20 Lerner, Shereen A; We Can Work Together: Cooperative Efforts Bring Results in Arizona.
- 8:40 Johnson, Michael F; Fifteen Years of Volunteerism: Only a Prelude.
- 9:00 Patterson, Leland W; The Role of the Avocational in Regional Archaeology.
- 9:20 Hume, Gary W & Richard A Boisvert; Philosophy and Practice in an Avocational/ Professional Archaeological Program: SCRAP, a New Hampshire Model.
- 9:40 Davis, Hester A & Bob Cooper; Training Avocational Archaeologists in Arkansas.
- 10:00 BREAK
- 10:20 Lange, Richard C; A Role for Avocationalists and Volunteers: A View From the Academic World.
- 10:40 Doelle, William H; Enhancing Research Through the Use of Volunteers.
- 11:00 Hooe, Paul E; Archaeological Resource Awareness: A Key to Effective Educational Programs About the Past in Licking County, Ohio.
- 11:20 Brown, James & Mark Lynott; Affiliated Archaeological Societies From a Professional's Perspective.
- 11:40 Discussant: Dincauze, Dena F

[512] Symposium: Recent Analyses and Interpretations of Modoc Rock Shelter (Randolph County, Illinois)

Magnolia

Organizer & Chair: Ahler, Steven R

Participants

- 8:00 Fowler, Melvin L & Steven R Ahler; Modoc Rock Shelter, Randolph County, Illinois: Perspectives on Research Questions, Stratigraphy, and Chronology.
- 8:20 Hajic, Edwin; Geomorphology, Stratigraphy, and Landscape Evolution of the Modoc Rock Shelter in the Mississippi Valley.
- 8:40 Theler, James & David A Baerreis (deceased); Environmental and Climatic Implications of Terrestrial Snails at Modoc Rock Shelter.
- 9:00 King, Frances B; Archaic Period Plant Use at Modoc Rockshelter, Randolph County, IL.
- 9:20 Styles, Bonnie, Karli White & James R Purdue; Shifts in Archaic Period Faunal Exploitation in the Mississippi River Valley: Modoc Rock Shelter Revisited.
- 9:40 BREAK
- 10:00 Anderson, Eve; New Perspectives on Mortuary Behavior at Modoc Rockshelter.
- 10:20 Ahler, Steven R, Bonnie W Styles & Melvin L Fowler; Changes in Archaic Period Site Function at Modoc Rock Shelter (Randolph County, Illinois).
- 10:40 Discussants: Klippel, Walter E & Russell Graham

[513] General Session: Southwest

Audubon E

Chair: Creamer, Winifred

Participants

- 10:10 Cordell, Linda & Murray Gell-Mann; An Experiment in Multidisciplinary Group Discussion of Southwest Prehistory.
- 10:25 Seymour, Deni; New Approaches to the Study of Intramural Space.
- 10:40 Kang, Bong Won; A Preliminary Study of the Relationship Between House Orientations and Thermal Efficiency.
- 10:50 Lowell, Julie C; Illuminating Fire Feature Variability in the Grasshopper Region of Arizona.

- 11:05 Sullivan, Alan; Extramural Plant-Processing Technology: Feature, Artifact, and Botanical Evidence From the Upper Basin.
- 11:20 Rocek, Thomas; Sedentism and Agricultural Dependence: Perspectives From the Pithouse to Pueblo Transition in the American Southwest.
- 11:35 Creamer, Winifred; Protohistoric Demography in the Northern Rio Grande Valley, New Mexico: New Interpretation From San Marcos Pueblo.
- 11:50 Morales, Thomas; Rio Grande Glazeware Ceramic Specialization: A Resource Buffering Strategy?

[514] General Session: Posters: Field and Laboratory Techniques; Site and Landscape Formation

Exhibition Hall

Participants

- 1 Stephen, David & Helen O'Brien; Archaeological Application for Global Positioning Systems.
- 2 Glass, Charles E, Christopher J Doolittle & Ben K Sternberg; Preliminary Subsurface Mapping of Archaeological Sites Using Ground Penetrating Radar.
- 3 Canouts, Veletta, Worthy N Martin & Ronald L Bishop; Computer-Aided Analysis of Design: System Overview.
- 4 Schiffer, Michael B & James M Skibo; Surface Treatments and Thermal Response: An Experimental Study of the Clay Cooking Pot.
- 5 Ericksen, Annette G & C George Hinkle; Flotation in the Lab: A New Technique to an Old Problem.
- 6 Carroll, Mary S; Design, Implementation and Management of Database Systems: Issues and Challenges.
- 7 Marchbanks, Michael; Preliminary Results of Organic Residue Analysis of Tiwanaku Ceramics.
- 8 McMann, Jean M; Site and Structure: Designing an Irish Megalithic Landscape.
- 9 Binford, Lewis R & Steven L Kuhn; Mousterian Site Structure and Social Organization.
- 10 Kardulias, P Nick; Archaeology at the Crossroads—Classical and Anthropological Archaeology at the Sanctuary of Poseidon, Isthmia, Greece.
- 11 Dalbey, Timothy; Patination as a Relative Dating Technique.
- 12 Falconer, Steven & Jennifer E Jones; Ceramic Deposition and Village Organization at Tell el-Hayyat, Jordan.
- 13 Jones, Jennifer; Standardized Ration Containers: Coarse Conical Bowls From Abu Salabikh, Iraq.

[515] General Session: Eastern North America

Mimosa

Chair: Schroedl, Gerald F

Participants

- 8:00 Cremin, William; Seeking An Identity for the Potawatomi: The Berrien Phase of the Southern Lake Michigan Basin.
- 8:15 Hamilton, M Colleen & Nicholas Herrmann; Jefferson Avenue Cemetery: An Historical and Bioarchaeological Perspective.
- 8:30 Molnar, James; The Odawa: Algonquians on the Ontario Iroquoian Frontier.
- 8:45 Curran, Mary Lou & John R Grimes; Patterns of Lithic Discard in New England Paleoindian Sites: is There Migration Evidence?
- 9:00 Bolian, Charles & Justine Gengras; Early and Middle Woodland Occupation of the Northern Connecticut Valley.
- 9:15 Dent, Richard J & Christine A Jirikowic; Excavations at the Hughes Site: Late Prehistory in the Potomac River Valley.
- 9:25 Whyte, Thomas R; Prehistoric Archaeological Records of the Roanoke Rockbass (*Ambloplites cavifrons*) in Virginia.
- 9:35 Johnson, William C & D Scott Speedy; Cultural Continuity and Change in the Middle and Late Woodland Periods in the Upper James Estuary, Prince George County, Virginia.
- 9:50 Shackel, Paul; Domestic Life in the Early Industrial Era.
- 10:05 BREAK

- 10:20 Judge, Christopher & Steven D Smith; Acquiring the Past for the Future: The South Carolina Heritage Trust Project.
- 10:35 Quitmyer, Irvy R, Douglas S Jones & William S Arnold; Incremental Shell Formation in the Hard Clam *Mercenaria* spp and its Use in Determining the Paleoseasonality of Coastal Shell Middens.
- 10:50 Mainfort, Robert & Richard Walling; Calibrated Middle Woodland Chronology for the Mid-South.
- 11:05 King, Adam; A New Ceramic Sequence for the Etowah Site, Bartow, Georgia.
- 11:20 Schroedl, Gerald; Archaeological and Ethnohistorical Perspectives on Cherokee Public Architecture.
- 11:35 Fontenot, Wonda Lee; The Medical Ethnobotany of Rural African Americans.

SATURDAY AFTERNOON APRIL 27, 1991

[601] Symposium: The Transition to Agriculture: New World

Grand Ballroom Salon A
Organizer & Chair: Price, T Douglas

Participants

- 1:30 Blake, Michael, Brian Chisholm & John E Clark; A Reconsideration of the Role of Maize in Early Lowland Agriculture in Mesoamerica.
- 1:50 Smith, Bruce D; The Origins of Agriculture in Eastern North America.
- 2:10 Smiley, Francis; Rapid Adoption of Agriculture in Constrained Regional Space: A Diffusion Simulation Approach.
- 2:30 Wills, Wirt; Foraging Systems and Plant Cultivation During the Emergence of Agricultural Economies in the Prehistoric American Southwest.
- 2:50 Hayden, Brian; Contrasting Expectations in Theories of Domestication.
- 3:10 Discussant: Flannery, Kent V

[602] Sponsored Symposium: Archaeology for the Public

Tulane
Organizers: Smith, George S & Nancy Hawkins
Chair: McGimsey, Charles R III

Participants

- 1:00 McGimsey, Charles R III, Jeremy A Sabloff & Kathleen M Byrd; Opening Remarks.
- 1:15 Milanich, Jerald T; Spaniards and Native Peoples in the Southeast United States.
- 1:50 Doran, Glen; The Windover Site: 8000-Year-Old Preserved Burials From Florida—A Delicate Balance.
- 2:25 BREAK
- 2:35 Goodwin, R Christopher; The Prehistory and History of New Orleans.
- 3:10 Essay Awards Presentation.

[603] Symposium: Cultural Diversity and Interaction: Prehistory of the Upper San Juan Drainage Basin, Northwestern New Mexico

Audubon C
Organizers: Reed, Lori Stephens & Paul F Reed
Chair: Reed, Lori Stephens & Gary L Moore

Participants

- 1:30 Kearns, Timothy; In the Beginning: The Preceramic Occupation of the Upper San Juan Drainage Basin in New Mexico and Colorado.
- 1:50 Bertram, Jack & Nancy S Hammack; Half-Baked Ovens: Further Excavations at the Ovens Site, LA 4169, Navajo Reservoir.
- 2:10 Cushman, David; Raw Material Selection, Reduction, and Use: A Study of Anasazi Lithic Technology in the La Plata Valley, New Mexico.

- 2:30 Shields, William Lane & John D Cater; The Cedar Hill Project.
- 2:50 Klausen-Bradley, Roberta; Springs, Seeps and Sites: Hunters and Gathering Systems in the Southern Mesa Mountains of Northwestern New Mexico.
- 3:10 Hancock, Patricia & Gary Brown; The Dineta Phase in the La Plata Valley of Northwestern New Mexico.
- 3:30 Wheelbarger, Linda & Ann Crowe; Early Navajo History in the Dineta Area, Northwest New Mexico.
- 3:50 Moore, Gary L; Navajo Burial Practices.
- 4:10 Reed, Lori Stephens & Paul F Reed; The Protohistoric Navajo: Implications of Interaction and Exchange With the Northern Rio Grande Pueblos.
- 4:30 Jacobson, LouAnn & Stephen L Fosberg; Paranoia Runs Deep in the 18th-Century.
- 4:50 Discussants: Cordell, Linda & Jonathan Haas

[604] Symposium: Peru's South Coast: An Emerging Research Frontier

Cypress
Organizer & Chair: Kowta, Makoto

Participants

- 1:30 Orefici, Giuseppe; Evidence of the Preceramic Ritual Use of the Ceremonial Center of Cahuachi.
- 1:50 Robinson, Roger; Recent Excavations at "Hacha" in the Acari Valley, Peru.
- 2:10 Katterman, Grace; Initial Period Cotton Textiles From Hacha.
- 2:30 Proulx, Donald A; Stylistic Variation in Proliferous Nasca Pottery.
- 2:50 Clarkson, Persis B & Ronald I Dorn; Applications of Radiocarbon Dating on Rock Varnish in the Nazca Region of Southern Peru.
- 3:10 BREAK
- 3:30 Kent, Jonathan D & Makoto Kowta; Gods, Graves, and Cists at Tambo Viejo, Acari Valley, Peru.
- 3:50 Howell, Carol & Jonathan D Kent; Counting Camelids Without A Quipu: Internal Features of "Corrals" at Quebrada de la Vaca, Southern Central Coast, Peru.
- 4:10 Barnes, Monica; Early Spanish Settlement and Agriculture on the South Coast of Peru.
- 4:30 Discussant: Riddel, Francis A

[605] Symposium: Using Archaeometry: The Role of Physical Sciences in Archaeology

Magnolia
Organizer & Chair: Pierce, Christopher

Participants

- 1:30 Holland, Thomas & Michael J O'Brien; Evolutionary Selectionism and the Role of Archaeometry.
- 1:50 Neiman, Fraser; On the Intersection of Archaeometry and Evolutionary Theory in Archaeological Inference.
- 2:10 McCutcheon, Patrick; Explaining Lithic Heat-Treatment Technology.
- 2:30 Durand, Stephen R; On Separating Function and Style in Chaco Architecture.
- 2:50 Pierce, Christopher; Distinguishing Style and Function in Poverty Point Objects.
- 3:10 Hunt, Terry L; Ceramic Provenance and Island Laboratories: Methodological Implications From Research in Oceania.
- 3:30 Aronson, Meredith; Modes of Manufacture: A Case From Preclassic West Mexico.
- 3:50 Feathers, James K; Thermoluminescence Dating of Southeast Missouri Pottery and the Problem of Radioactive Disequilibrium.
- 4:10 Ericson, Jonathon E; Lifeways of the Individual in Prehistory.
- 4:30 Greenlee, Diana; Patterns in Late Prehistoric Subsistence Through Mass Spectrometric Analysis.
- 4:50 Discussants: Bishop, Ronald L & Robert C Dunnell

[606] Symposium: Cave and Rockshelter Formation Processes

Audubon E
Organizers & Chairs: Nash, David T & Michael D Petraglia

Participants

- 1:30 Goldberg, Paul & Richard I MacPhail; Sedimentary Processes in Gorham's Cave, Gibraltar.
- 1:50 Farrand, William R; Discontinuity in the Stratigraphic Record: Snapshots From Franchthi Cave, Greece.
- 2:10 Butzer, Karl W; Discontinuous, Late Quaternary Cave Occupation in Southern Africa.
- 2:30 Stafford, Thomas W, Jr; Stratigraphy and Geochronology of Island and Continental Cave Deposits.
- 2:50 Barton, C Michael & G A Clark; Upper Pleistocene Cave Site Formation Processes in Europe and the Levant.
- 3:10 Dawson-Saunders, Beth & Jeffrey J Saunders; Pseudotools From an Early Pleistocene Hyena Den, Punjab Province, Pakistan.
- 3:30 Nash, David T; Distinguishing Artifacts From Naturefacts Created in Cave and Rockshelter Contexts.
- 3:50 Koetje, Todd; Site Formation Processes and Behavioral Deposition Episodes: The View From Le Flageolet II.
- 4:10 Crothers, George M & Patty Jo Watson; Formational Contexts of Deep Cave Sites in the Eastern Woodlands of North America.
- 4:30 Graham, Martha; Gimme Shelter: Constraints on the Organization and Use of Space in Rockshelters.
- 4:50 MacNeish, Richard S; Pre-Clovis Barrier Broken in Pendejo Cave?
- 5:10 Discussants: Straus, Lawrence G & Jean-Philippe Rigaud

[607] Symposium: A Reappraisal of the Late Intermediate Period

Audubon A

Organizer & Discussant: Bauer, Brian Scott

Participants

- 1:30 Burgi, Peter; The Problem of Political Units at the Outset of the Late Horizon: The Case of the Torata Valley, South-Central Andes.
- 1:50 Bauer, Brian; Late Intermediate Subsistence-Settlement Systems of the Cuzco Region.
- 2:10 Parsons, Jeffrey; Local and Regional Organization in the Upper Mantaro-Tarma Drainage, Peru, AD 500-1500.
- 2:30 Hastings, Charles; Small Sites in Late Intermediate Settlement Patterns of the Eastern Peruvian Andes.
- 2:50 Grosboll, Sue; Late Intermediate Growth and Change in the Huanuco Hinterlands.
- 3:10 Julien, Daniel G; Cajamarca, Peru, During the Late Intermediate Period.
- 3:30 Bray, Tamara; Inca Intervention in the Pais Caranqui, Northern Ecuador.

[608] Symposium: Drinking in the Past: Archaeological Perspectives on Alcohol and its Social Roles

Audubon B

Organizer & Chair: Dietler, Michael

Participants

- 1:30 Geller, Jeremy; From Prehistory to History: Socioeconomic Roles of Beer in Ancient Egypt.
- 1:50 Arnold, Bettina; "Drinking the Feast": Alcohol and the Legitimation of Power in Iron Age Europe.
- 2:10 Dietler, Michael; Watching Where the Wine Flows: Alcohol Consumption and Political Economy in Iron Age France.
- 2:30 Engs, Ruth C; Romanization and Drinking Norms: A Model to Explain Differences in Modern Society.
- 2:50 Morris, Craig; Maize Beer, Value, and Political Process in the Andes.
- 3:10 Herbich, Ingrid; The Flow of Drink in an African Society: An Ethnoarchaeological Perspective.
- 3:30 Discussant: Heath, Dwight B

[609] Symposium: The Craft of Archaeology

Grand Ballroom Salon C

Organizers & Chairs: McGuire, Randall H & Michael Shanks

Participants

- 1:30 McGuire, Randall & Michael Shanks; The Craft of Archaeology.
- 1:50 Saitta, Dean; Marxism and the Middle Range.
- 2:10 Bender, Barbara; Stonehenge 4000 BC-AD 2000: A Political Landscape.
- 2:30 Patterson, Thomas C; Marxist Analyses and the Rise of Civilization: A Methodological Statement.
- 2:50 Brumfiel, Elizabeth M; Making History in Xaltocan.
- 3:10 Johnson, Matthew H; Towards an Archaeology of Capitalism.
- 3:30 Potter, Parker; Where Do Our Questions Come From, and Where Do the Answers Go?
- 3:50 Kent, Susan; A Methodological Bridge Between Theory and Data.
- 4:10 Clark, Lynn; A Multi-Voiced Past: Integrating Archaeological and Native American Indian Views of Iroquois Gender Roles.
- 4:30 Wylie, Alison; Taking Up the Slack: Gender/Archaeology and the Evaluation of Multiple Working Hypotheses.
- 4:50 Preucel, Robert W & Steven Pendery; Utopian Visions and the Ideology of Brook Farm.
- 5:10 Discussants: Salmon, Merrilee

[610] Symposium: House, Temple, Cemetery, Enclosure: Arenas of Social Power in the Prehistory of Southeast Europe

Grand Ballroom Salon B

Organizer & Chair: Chapman, John

Participants

- 1:30 Chapman, John; Arenas of Social Power in Prehistory: The Varna Cemetery and the Bulgarian Copper Age.
- 1:50 Tringham, Ruth & Mirjana Stevanovic; Vinca Domestic Architecture as Arenas of Household/Gender Tensions.
- 2:10 Bökönyi, Sándor; Finding a Home for Animals in Hungarian Prehistory.
- 2:30 Raczky, Pál; Settlement Boundaries and the Creation of Social Space in Neolithic Hungary.
- 2:50 Ellis, Linda; Settlements, Satellites, Salt, and Clay: An Arena of Ecological Control From the Neolithic in Eastern Romania.
- 3:10 BREAK
- 3:30 Greenfield, Haskel J; Transhumant Pastoralism and the Emergence of Complex Societies in the Highlands of SE Europe.
- 3:50 Gaffney, Vincent; The Division of Land and Ritual Power in Dalmatian Later Prehistory.
- 4:10 Mason, Philip Frederick John; Barrows, Hillforts, and the Early Iron Age in Slovenia.
- 4:30 Anthony, David; Tripolye Mega-Sites of the Fourth Millennium BC: Growth and Decline.
- 4:50 Discussant: Wailes, Bernard

[611] Symposium: Hunting Techniques and Technology in the Later Paleolithic and Mesolithic of Eurasia

Audubon D

Discussant: Bricker, Harvey M & Gail Larsen Peterkin

Participants

- 1:30 Churchill, Steven E & Bryan K Curran; Weapon Technology, Prey Size Selection, and Hunting Methods in Modern Hunter-Gatherers and Implications for Paleolithic Archaeology.
- 1:50 Shea, John J; Lithic Use-Wear Evidence for Hunting by Neandertals and Robust Modern Humans From the Levantine Mousterian.
- 2:10 Kuhn, Steven L; Technology as Adaptive Response: Evidence for Composite Weapons in the Middle Paleolithic

- 2:30 Peterkin, Gail L; Upper Paleolithic Hunting Technology in Southwestern France.
- 2:50 Knecht, Heidi D; Early Upper Paleolithic Approaches to Bone and Antler Projectile Technology.
- 3:10 Soffer, Olga; Fur or Food, Feast or Famine: Eastern Gravettian Man-Carnivore Relationships.
- 3:30 Harrold, Francis B; Variability Among Gravette Points From the Perigord.
- 3:50 Olaszewski, Deborah I; Microliths as Hunting Tool Components at Warwasi Rockshelter, Iran.
- 4:10 Bergman, Christopher; Prehistoric Archery Tackle: Late Paleolithic and Mesolithic Europe.
- 4:30 Mithen, Steven J; Technology, Hunting, and Social Organization in the Mesolithic of Northern Europe.
- 4:50 Mellars, Paul A; Mesolithic Hunting Strategies in Britain.
- 5:10 Discussant: Otte, Marcel

[612] General Session: Researching Taphonomy and Site Formation Processes

Audubon A
Chair: Gifford-Gonzalez, Diane P

Participants

- 4:00 Nielsen, Axel; Where do Microartifacts Come From?
- 4:10 Prentiss, William C; Flake Utility and the Formation of a Housepit Floor Lithic Assemblage.
- 4:25 Archer, Gavin H; Artifact Size and Frequency in the Analysis of Hohokam Habitation Refuse Using a High Resolution Method.
- 4:35 Billeck, William; What You See May Not Be What You Get: Surface-Subsurface Artifact Distribution Relationships.
- 4:45 Black, Andrew T; The Effects of Cooking on the Fracture Pattern of Bovine Bone.
- 4:55 Kenyon, Dienne M E; Chopping and Sawing: How to Portion the Beasts.
- 5:10 Gifford-Gonzalez, Diane; An Analytic Approach to Carcass Processing Residues.
- 5:25 Wilson, Douglas C; The Implications of Ethnicity on Household Secondary Refuse Deposition: A Garbage Project Case Study.

[613] General Session: Researching Symbolism, Style, and Ritual

Tulane
Chair: Sackett, James R

Participants

- 3:40 Sackett, James; Stone Tools and Stone Age Symbolism.
- 3:55 Fletcher, Thomas; Ceramics and Social Networks in Early Neolithic Central Europe.
- 4:10 Bass, Patricia M; The Interpretation of US Rock Art: Is It Time to Move to "Meta-Rules"?
- 4:25 Stoffel, Diane E; Status and Symbol on Mimbres Naturalistic Bowls.
- 4:40 Lekson, Stephen; Ritual and the Hohokam Region.
- 4:55 Shackley, M Steven; Projectile Point Technology of Ishi and the Yahi-Yana: Inferences for Hunter-Gatherer Style and Ethnicity.
- 5:10 Little, Barbara J; Cyclical Change in Mortuary Display: An Example From 19th-Century Virginia.

[614] General Session: Researching Production, Use, and Distribution of Lithic Materials in North America

Grand Ballroom Salon A
Chair: Bienenfeld, Paula F

Participants

- 3:45 Haynes, John; Lithic Utilization: Regional and Intrasite Variations in the Middle Potomac Drainage.

- 3:55 Purrington, Burton; Lithic Selection and Procurement in the Bald Mountains of Western North Carolina.
- 4:05 Bienenfeld, Paula; The Lithic Assemblage From the Snodgrass Site, a Mississippian Powers Phase Village.
- 4:20 Schneider, Joan S; Stone Quarrying for the Production of Aboriginal Milling Implements.
- 4:35 Gundersen, James & Mark Elson; Mineralogy of Argillite Artifacts: Trade and Exchange in the American Southwest.
- 4:50 Bayman, James M & Sara P Chavarria; Recovery Context and Craft Production Studies: A Hohokam Example.

[615] General Session: New World

Mimosa
Chair: Houston, Stephen

Participants

- 1:30 Hester, James J; Discovery of the Oldest Recorded Totem Poles on the Northwest Coast.
- 1:40 Downer, Alan; Navajo Nation Management of Traditional Cultural Properties.
- 1:55 Johnson, Rudolph H, Elizabeth L Ambos & William S Mah; Geophysical Surveys of Anasazi Sites in Southwestern Utah.
- 2:05 van Hartesveldt, Eric N; The Evolution (and Devolution) of an Anasazi Community.
- 2:20 Benallie, Larry; Linear Archaeology Between Klagehoh and Wide Ruins, Navajo Nation.
- 2:30 Ridings, Rosanna; Thermal Histories of Obsidian Artifacts From Pot Creek Pueblo: Implications for Obsidian Hydration Dating.
- 2:45 Bremer, J Michael & Anne R Baldwin; Progress or Contingency: New Explanations for the Development of Community and Organizational Complexity Among Populations on the Southern Colorado Plateau.
- 3:00 Warren, Claude N; Early Holocene Peoples of the Mojave Desert: A Case of Cultural Adaptation?
- 3:15 Rhode, David; Paleoenvironmental Reconstructions From Plant Remains at Danger Cave and Vicinity, Western Bonneville Basin: A Progress Report.
- 3:25 Mack, Joanne; Prehistory of the Upper Klamath River, Oregon and California.
- 3:40 Armstrong, Douglas V & Kenneth G Kelly; Processes of Change and Patterns of Meaning in a Jamaican Slave Village.
- 3:55 Curet, Luis Antonio; House Structure and Sociopolitical Change in the Caribbean: Three Case Studies From Puerto Rico.
- 4:05 Hendon, Julia A; Weaving and Spinning in Pre-Hispanic Mesoamerica: The Technology and Social Relations of Textile Production.
- 4:20 Hawkins, Susanna; An Assessment of the Magnitude of Textile Production in Mesoamerica and a Model for the Archeological Recognition of Fibre Cultivation and Processing.
- 4:35 Valdez, Fred, Jr & Palma J Buttles; G-103: A Late Preclassic Monumental Structure at Rio Azul, Guatemala.
- 4:45 Houston, Stephen; Hieroglyphs and History at Dos Pilas, Guatemala.
- 4:55 Widmer, Randolph; Excavations at the Elite Terminal Classic Site, 8N11, Copan: An Example of Archaeological Data Recovery During Restoration.
- 5:10 Gonlin, Nancy & David Reed; Are All Commoner Houses Created Equally?
- 5:25 Ausec, Marne & Patricia Urban; When the Walls Speak: The Study of Wattle and Daub Fragments as a Guide to Activity Reconstructions.

[616] General Session: Old World

Audubon B
Chair: Whalen, Norman

Participants

- 3:55 Whalen, Norman, David W Pease & Michael R Waters; Archaeological Survey in Southwest Yemen.
- 4:05 Chazan, Michael; The Hybrid Mousterian of Haua Fteah, Libya.
- 4:15 Coinman, Nancy; Upper Paleolithic Assemblage Variability From the Southern Levant.

- 4:30 Bousman, Britt; Settlement-Mobility Strategies and Assemblage Formation Processes in the Later Stone Age of Southern Africa.
- 4:45 Polglase, Christopher; Community and Household Variation in Obsidian Production and Use During the Early Neolithic of Southern Italy.
- 5:00 Gallin, Lenore; The Architecture of the Nuraghi Towers of Bronze Age Sardinia.
- 5:10 Stark, Ken; The Development of Rice Agriculture in Prehistoric Japan: Varying Rates of Change Along Divergent Pathways.
- 5:25 Weisler, Marshall & Robert H Gargett; The Taphonomy of Extinction: Evaluating the Direct Role of Humans in Reducing Avian Populations on Insular Landscapes.

SUNDAY MORNING APRIL 28, 1991

[701] Symposium: Animal Exploitation in the Later Paleolithic and Mesolithic of Eurasia

Grand Ballroom Salon B
Organizer & Chair: Mellars, Paul A

Participants

- 8:00 Clark, G A & M P Neeleyh; The Human Food Niche in the Levant Over the Past 150 KYR.
- 8:20 Lieberman, Daniel E; Diachronic Changes in the Seasonal Hunting of Gazelles in the Levant by Hunter-Gatherers From the Mousterian to the Natufian.
- 8:40 Stiner, Mary C; On Hunting, Scavenging and Gathering in the Mousterian.
- 9:00 Boyle, Katherine; Upper Paleolithic Procurement and Processing Strategies in Southwest France.
- 9:20 Burke, Ariane; Applied Skeletochronology: The Seasonal Importance of Horse as Prey During the Pleniglacial in Southwestern France.
- 9:40 Pike-Tay, Anne; The Inference of Paleolithic Hunting Strategies From Archaeofaunas: A Cautionary Note.
- 10:00 BREAK
- 10:20 Delpech, Françoise, Donald K Grayson & Jean-Philippe Rigaud; The Technology of Early Upper Paleolithic Subsistence at Le Flageolet I: A Rockshelter of the Perigord.
- 10:40 Enloe, James G & Francine David; Implications of Marrow Processing for Hunter/Gatherer Subsistence Organization in the Later Paleolithic of Western Europe.
- 11:00 Straus, Lawrence G; Upper Paleolithic Hunting Tactics and Weapons in Southwestern Europe.
- 11:20 Rowley-Conwy, Peter A; Season and Reason: Diagnosis of Season and Purpose of Occupation of Danish Mesolithic Settlements From Faunal Remains.
- 11:40 Discussant: Price, T Douglas

[702] Symposium: Site Formation Processes—New Techniques and Cultural Implications

Grand Ballroom Salon A
Organizers & Chairs: Bar-Yosef, Ofer & Paul Goldberg

Participants

- 8:00 Petraglia, Michael & Richard Potts; Water Flow and the Formation of Early Paleolithic Sites in Olduvai Gorge, Tanzania.
- 8:20 Courty, Marie-Agnes; The Concept of Cultural Layers and Living Floors Through the Microscope.
- 8:40 Speth, John D & Eitan Tchernov; Taphonomic and Behavioral Implications of the Kebara Cave Fauna: A Preliminary Investigation.
- 9:00 Weiner, Steve; Bone Preservation in Kebara Cave, Israel: An Onsite Fourier Transform Infrared Study.
- 9:20 Phillips, James L & Bruce G Gladfelter; The Role of Refitting in Understanding Site Formation Processes at Three Upper Paleolithic Sites in Southern Sinai.
- 9:40 Zilhão, João, Reid Ferring & Anthony Marks; Geology and Site Formation Processes of Upper Paleolithic Sites in the Portuguese Estremadura.
- 10:00 Factor, Jennifer L; Cayönü Tepesi, Turkey: Micromorphology at a Neolithic Tell.

- 10:20 Whitbread, Ian & Paul Goldberg; Micromorphological Aspects of Bedouin Tent Deposits and Their Implications in Archaeology.
- 10:40 Rosen, Arlene Miller; Microartifacts as a Reflection of Cultural Factors in Site Formation.
- 11:00 Stein, Julie K; The Formation and Deformation of Shell Middens: Effects on Interpretations of Coastal Adaptation.
- 11:20 Audouze, Françoise; Site Formation Processes in Verberie, a Magdalenian Site in the Paris Basin.
- 11:40 Discussants: Perlès, Catherine & Michael B Schiffer

[703] Symposium: Experimental, Ethnographic, and Archaeological Observations on the Use and Abuse of Ground Stone

Audubon B
Organizers: Mauldin, Raymond & Lee Fratt
Chair: Mauldin, Raymond

Participants

- 8:00 Walker, William & Lee Fratt; Under the Weather: A Systematic Study of Weathering on Ground Stone Artifacts Recovered From Survey.
- 8:20 Bostwick, Todd & James Burton; A Study in Sourcing Basalt Materials Used for Groundstone Tools in the Sonoran Desert.
- 8:40 Hard, Robert J & Aslihan Yener; The Function of Anatolian Ground and Battered Tools.
- 9:00 Wright, Mona; Experimental Use of Early Pueblo Maize Grinding Tools From Southwestern Colorado.
- 9:20 Fratt, Lee; Ground Stone Artifacts and Seasonality: Some Conclusions Suggested by the Homol'ovi III Assemblage.
- 9:40 Adams, Jenny L; The Mechanics of Manos and Metates and Grinding Intensification.
- 10:00 BREAK
- 10:20 Mauldin, Raymond; Thumping and Grinding: Ethnographic Observations on Ground Stone From the Andes.
- 10:40 Nelson, Margaret C & Heidi Lippmeier; Ground Stone Design as Conditioned by Land Use Strategy.
- 11:00 Stone, Tammy; Inferences of Occupational History and Function of Small Sites From Ground Stone.
- 11:20 Discussants: Schlanger, Sarah & Brian Hayden

[704] Symposium: Gender Relations in Prehistory: A Biosocial Perspective

Grand Ballroom Salon C
Organizers: Boone, James L & Katharine Fuller
Chair: Fuller, Katharine

Participants

- 8:00 Boone, James L; Evolutionary Models, Moral Conclusions: Who is Committing the Naturalistic Fallacy?
- 8:20 Kaplan, Hillard & Jane Lancaster; An Evolutionary Ecological Model of Gender Relations.
- 8:40 Juell, Kenneth E; Hominid-Pongid Divergence and Subsequent Hominid Evolution: The Small Animal Hunting Hypothesis.
- 9:00 Boden, Martha; Woman the Predator: Female Meat Procurement Strategies in Foraging Societies.
- 9:20 Reyrcraft, Richard M; Fertility, the Division of Labor, and the Costs of Children Among Hunter-Gatherers.
- 9:40 Mick-O'Hara, Linda; Nutritional Status and Variability Within Classic Period Puebloan Populations in the American Southwest.
- 10:00 Fuller, Katharine; Laws on Her Body: Female Sexual and Economic Control in Horticultural and Agricultural Systems.
- 10:20 Discussants: Lancaster, Jane B & Lewis R Binford

[705] Symposium: Metals in Society: Theory Beyond Analysis

Magnolia

Organizer & Chair: Ehrenreich, Robert M

Participants

- 8:00 Bradley, James W & S Terry Childs; Panthers' Tails and Basque Earrings: The Form of Cross-Cultural Contact in 16th-Century Iroquoia.
- 8:20 McCartney, Allen P; Canadian Arctic Trade Metal: Reflections of Prehistoric to Historic Social Networks.
- 8:40 Leader, Jonathan M; The South Florida Metal Complex: A Preliminary Discussion of the Effects of the Introduction of an Elite Material on a Contact Period Native American Society.
- 9:00 Geselowitz, Michael N, Thomas R Westcott & Dana Wang; For Want of a Nail: Archaeometallurgy and Dating in Historical Archaeology.
- 9:20 Hall, Mark E; Technology and Style: The Hiberno-Norse Case.
- 9:40 Childs, S Terry; Copper and Bronze: Adjacent Technologies in Central Africa.
- 10:00 Discussants: Stech, Tamera, Vince Pigott & Peter S Wells

[706] Symposium: The Reemergence of the Landscape Approach in Archaeology

Tulane

Organizer & Chair: Green, Stanton W

Participants

- 8:00 Green, Stanton; Landscape as an Integrative Concept in Archaeology.
- 8:20 Allen, Kathleen M; Landscape Theory and Archaeological Interpretation.
- 8:40 Frake, Charles & Ezra Zubrow; The Cultural Construction of Past Landscapes.
- 9:00 Fleming, Andrew; Landscape Archaeology: The Quest for Theory.
- 9:20 Zvelebil, Marek; Landscapes and Archaeology: Problems of Interpretation.
- 9:40 BREAK
- 10:00 Macklin, Mark; Prehistoric Landscape Change in Ireland: A Geomorphological and Paleoenvironmental Perspective.
- 10:20 Rossignol, Jacqueline; Time, Ethnoarchaeology, and the Landscape Approach.
- 10:40 Discussants: Bradley, Richard & Carole Crumley

[707] Symposium: Basketmaker III: New Methods, New Theories

Audubon C

Organizers: Altschul, Jeffrey H & Roger Anyon

Chair: Altschul, Jeffrey H

Participants

- 8:00 Toll, Wolcott; Patterns of Basketmaker III Occupation in the La Plata Valley, NM.
- 8:20 Homburg, Jeffrey & William C Johnson; Landscape Evolution in Relation to Basketmaker III Occupation of the Lukachukai Valley.
- 8:40 Anyon, Roger & Lawrence C Todd; Tempo, Duration, and Sequence: Microstratigraphic Excavation and Basketmaker III Settlement Systems.
- 9:00 Latady, William R, Jr, Martha Graham & Lawrence C Todd; Time and Time Again: The Archaeology of Abandonment, Reuse, and Reoccupation.
- 9:20 Skinner, Elizabeth J & Mark Sant; Spatial Analysis and Site Structure of Basketmaker III Pitstructure Villages.
- 9:40 Shelley, Steven D; The Potential for Distinct Populations During Basketmaker III on the Colorado Plateau.
- 10:00 Altschul, Jeffrey H; Social Complexity and Residential Stability During the Basketmaker III Period.
- 10:20 Discussant: Wills, Wirt & Patricia Gilman

[708] Symposium: Ecological and Cultural Determinants of Local Autonomy in South Coastal Peru

Audubon A

Organizer and Chair: Wise, Karen

Participants

- 8:00 Wise, Karen; Preceramic Cultural Variability and Ethnic Diversity in the South-Central Andes.
- 8:20 Bawden, Garth; Early Agricultural Society on the Peruvian South Coast.
- 8:40 O'Donnabhain, Barra, M C Lozada & Jane Buikstra; Wawakiki: An Early Ceramic Cemetery Near Ilo, Peru.
- 9:00 Owen, Bruce; Economic and Political Developments in the Twilight of Tiwanaku.
- 9:20 Jessup, David; Chiribaya: Late Intermediate Period Cultural Transformations in the Ilo Area.
- 9:40 Satterlee, Dennis; Impact of El Niño Flooding on Prehistoric Agriculture in Southern Peru.
- 10:00 BREAK
- 10:20 Penman, Shawn L & Garth Bawden; The Burro Flaco Complex.
- 10:40 Tapia, Jorge & Michael Moseley; Large Magnitude El Niño Events in Southern Peru.
- 11:00 Williams, Sloan, Norman A Doggett & Jonathan L Longmire; Implications for the Use of Ancient DNA in the Ilo Valley.
- 11:20 Discussants: Conrad, Geoffrey & Michael Moseley

[709] Symposium: The Prehistoric Economy of the Ancient Maya: Recent Research of the Belize River Archaeological Settlement Survey

Cypress

Organizers: Ford, Anabel & Lisa Lucero

Chair: Ford, Anabel

Participants

- 8:00 Fedick, Scott; Modeling Prehistoric Maya Land-Use: The Application of Geographical Information Systems.
- 8:20 Ford, Anabel & George Michaels; Residential Land-Use, Social Status, and Consumption: The Methodological Foundation for the Belize River Archaeological Settlement Survey Phase II Intensive Excavations.
- 8:40 Steinberg, John; Labor Investment and Architecture: Method and Meaning.
- 9:00 Harrington, Lady & Berniece Skinner; Ceramic Analysis: Form, Function, and Meaning.
- 9:20 Lucero, Lisa; Maya Domestic Production and Consumption Patterns: Ceramic Distribution in the Belize River Area.
- 9:40 Olson, Kirsten; Long-Distance Exchange in the Maya Lowlands: Obsidian Production and Distribution in the Belize River Area.
- 10:00 Discussant: Price, Barbara J

[710] Symposium: Highland and Coastal Guatemalan Archaeology: Recent Research and New Perspectives

Audubon E

Organizers & Chairs: Arroyo, Barbara & Eugenia Robinson

Participants

- 8:00 Arroyo, Barbara; The Early Formative on the Central Pacific Coast of Guatemala.
- 8:20 Beaudry-Corbett, Marilyn; Intrasite Spatial Patterning and Household Organization at Sin Cabezas, a Site on the Coastal Plain of Guatemala.
- 8:40 Bove, Frederick J; The Paryuyu Project: A Test of the Hatch Hypotheses.
- 9:00 Hatch, Marion P; Archaeological Reconnaissance on the South Coast of Guatemala, 1990.
- 9:20 Orrego, Miguel; Recent Discoveries and Interpretations of the Abaj Takalik Project.
- 9:40 Gasco, Janine; Highland-Lowland Migration Patterns in Colonial Guatemala.
- 10:00 BREAK
- 10:20 Braswell, Geoffrey E; Obsidian Procurement, Economy, and Use: A View From the Maya Highlands.
- 10:40 Briggs, Jennifer & Geoffrey E Braswell; Obsidian Outcrops in the Kaqchikel Maya Highlands.
- 11:00 Garcia, Edgar; Recent Findings at Xecohil, a Maya Highland Site.
- 11:20 Benitez, Jose & Teresita Chinchilla; Santa Rosa Stela 1.

- 11:40 Orozco, Rebecca Jane; Puerto Izabal: An Underwater Archaeological Survey of an Historic Anchorage on Lago Izabal, Guatemala.

[711] General Session: Production, Distribution, Use of Ceramic Materials

Audubon D
Chair: Burton, James

Participants

- 8:00 Burton, James & Arleyn W Simon; Determination of Intraregional Exchange Through Ionic-Extraction Analysis of Ceramics.
8:15 Sassaman, Kenneth E; Gender and Technology in Prehistory.
8:30 Heidke, James; Application of the Petrofacies Concept to the Analysis of Archaeological Ceramics.
8:45 Bubemyre, Trixi D; Behavioral Implications of Hohokam Ceramic Variability: Feasting, Food Redistribution, or Craft Production?
9:00 Vitelli, Karen D; Possible Use of Plant Extracts by Prehistoric Potters.
9:10 Procter-Weiss, Rebecca & Bart Olinger; Raw Material Sources of Pottery From Taos, New Mexico: Results of X-Ray Fluorescence Analysis.
9:20 Urban, Patricia; Ceramic Manufacturing and Sociopolitical Complexity in Late Classic Southeastern Mesoamerica: Recent Work at La Sierra, Northwestern Honduras.
9:35 Neff, Louis & Edward Schortman; Late Postclassic Production and Sociopolitical Complexity in Southeastern Mesoamerica: Investigations of Viejo Brisas del Valle, NW Honduras.
9:50 BREAK
10:05 Yeatts, Michael; Compositional Analysis of Ceramics With the Electron Microprobe.
10:20 Purcell, Geoffrey; Teasing Patterns out of Pottery: Elemental Analysis, Statistics and Roman Amphorae in the Middle Danube Basin.
10:35 Kalogirou, Ada; Late Neolithic Pottery Manufacture and Use: A Case Study From Western Macedonia, Greece.
10:45 Hoffman, Christopher R; Beakers, Bone Buttons, and Bronze: Culture and the Technological Milieu of Copper Age Spain.
11:00 Morris, Elaine; Production and Distribution of Artifacts in the British Iron Age.
11:15 McDermott, Matthew J & Terry L Hunt; Inferring Ceramic Production and Distribution From Technological Variability: A Fiji Islands Case Study.

[712] General Session: Yucatan and Petén

Cypress
Chair: Graham, Elizabeth

Participants

- 10:30 Graham, Elizabeth; The 1990 Investigations at Marco Gonzalez, Ambergris Caye, Belize: Overview of Chronology, Settlement, and Site Formation.
10:40 Emery, Kitty; Marine Resource Availability and Use at the Marco Gonzalez Site, Belize: Present-Day Evidence From the Hol Chan Marine Reserve.
10:50 Cook, Patricia; Residential Construction on Albion Island, Belize
11:00 Garber, Jim, David Driver & Lauren Sullivan; Excavations at the Maya Site of Blackman Eddy in the Belize Valley, Belize: Results of the 1990 Field Season.
11:10 Pyburn, K Anne; Chau Hiix: A New Archaeological Site in Northern Belize.
11:20 McKillop, Heather & Lawrence Jackson; Trade and Ritual Among the Coastal Maya.
11:35 Lentz, David; Prehistoric Subsistence in the Petexbatun Region: Paleoethnobotanical Evidence.
11:45 Carmean, Kelli; Architectural and Ceramic Wealth in Sayil Households.

[713] General Session: Southwest

Audubon C
Chair: Phagan, Carl J

Participants

- 11:10 Elson, Mark; Preclassic Period Settlement in the Upper Tonto Basin: Prelude to Salado.
11:25 Phagan, Carl & Todd Swann; The Leschin Site: A Projectile Point "Shrine" Near Flagstaff, Arizona.
11:35 Shaw, Chester W; Prehistoric Maize Agriculture in West-Central and Southwest New Mexico: Climatic and Other Environmental Considerations.
11:50 Larson, Daniel O, Donald Graybill & Kenneth L Kvamme; Measuring Climatic Variability and Demographic Change: Theory Building Through Exploratory Data Analysis.

[714] General Session: Africa

Magnolia
Chair: LaViolette, Adria

Participants

- 11:10 Carvey, Andrea; Early Fire: Developing Criteria for Identifying Hominid Fire Use.
11:20 Sikes, Nancy E; Stable Isotope Analysis of Paleosols in Lower Bed II, Olduvai Gorge.
11:35 Spang, Thomas W; A Reanalysis of the "Zinjanthropus" and TK Lower Floor Artifact Assemblages From Olduvai Gorge.
11:50 LaViolette, Adria; Excavations at Pujini, a Swahili Fortification in Zanzibar.

[715] General Session: Europe: Raw Material Procurement, Technology, and Instrumented Approaches.

Grand Ballroom Salon C
Chair: Vierra, Bradley J

Participants

- 11:10 Dobres, Marcia-Anne; Production as Process, Artifacts as Artifice: Magdalenian Technology and the Prehistoric Social Organization of Labor.
11:25 Vierra, Bradley & Jose Morais Arnaud; The Effect of Lithic Raw Material Availability on Late Mesolithic Technology in Southern Portugal.
11:40 Manson, Joni L & Victor A Schmidt; Archaeomagnetic Dating of Neolithic Yugoslavian Potsherds.
11:55 Tykot, Robert H; Archaeological Applications of ICP-Mass Spectrometry: An Obsidian Case Study.

INDEX TO EXHIBITORS

- 203 & 205 **Academic Press, Inc.**
1250 Sixth Avenue
San Diego CA 92101
Academic Press is a publisher of scientific and technical books and journals
- 105 & 107 **Archaeological Assistance Division—Department of the Interior, National Park Service**
PO Box 37127
Washington DC 20013-7127
Publications produced by the AAD and other NPS Cultural Resources Program divisions; showing of "Assault on Time," a video on looting; and NADB computer demonstration
- 112 **Arkansas Archeological Survey**
PO Box 1249
Fayetteville AR 72702
Technical and popular publications published by Arkansas Archeological Survey
- 209 **Association of American University Presses**
584 Broadway, Suite 410
New York City NY 10012
We will feature the latest in the best university press books and journals. Filling the needs of the scholarly community
- 207 **Bureau of Land Management**
1849 C Street, NW
Washington DC 20240
ADVENTURES IN THE PAST traveling exhibit, brochure, strategic marketing plan and various interpretive materials
- 106 & 108 **Cambridge University Press**
40 West 20th Street
New York NY 10011
Books and journals in archaeology, anthropology and history
- 309 **CMVARI**
1245-C N Rapp Street
Columbia IL 62236
Archaeological publications and information from the Central Mississippi Valley, especially Cahokia the American Bottom
- 213 **COAS Publishing and Research**
317 North Main Street
Las Cruces NM 88001
New and used archaeological publications by one of the largest dealers in the United States
- 303 **International Expeditions, Inc.**
One Environs Park
Helena AL 35080
International Expeditions, Inc. specializes in natural history expeditions to 30 worldwide destinations, including areas of archaeological and anthropological interest. Since 1980, we have stressed environmental awareness, natural history education and resource conservation through outstanding ecotourism programs
- 202 **International Monographs in Prehistory**
PO Box 1266
Ann Arbor MI 48106-1266
Two monographs: Maya Stone Tools, published by Prehistory Press, and Ethnoarchaeological Approaches to Mobile Campsites published by International Monographs in Prehistory

- 110 **Mayfield Publishing**
1240 Villa Street
Mountain View CA 94041
College texts
- 212 **Nevada State Museum Anthropology Department**
600 North Carson Street
Carson City NV 89710
Nevada State Museum scientific publications and Nevada petroglyph t-shirts
- 313 **Oxbow Books**
PO Box 5605
Bloomington IN 47407
Academic books in Archaeology, displaying primarily methods/theory, prehistory. Books displayed at the meeting will be selected from British Institutes/publishers not represented in the U.S.
- 305 **Plenum Publishing Corporation**
233 Spring Street
New York NY 10013
Featuring: Bettinger—Hunter-Gatherers; Kroll/Price—Interpretation of Archaeological Spatial Patterning; Nassaney/Cobb—Stability, Transformation, and Variation; and Sinopoli—Approaches to Archaeological Ceramics
- 202 **Prehistory Press**
1705 Jefferson Street
Madison WI 53711
Two monographs: Maya Stone Tools, published by Prehistory Press and Ethnoarchaeological Approaches to Mobile Campsites, published by International Monographs in Prehistory
- 206 **Smithsonian Institution Press**
470 L'Enfant Plaza, Suite 7100
Washington DC 20560
New and backlist titles in archaeology, including The Greenland Mummies, Historical Archaeology in Global Perspective and Objects of Change: The Archaeology and History of Ankara Contact with Europeans
- 204 **Thames and Hudson**
500 Fifth Avenue
New York NY 10110
Archaeology books
- 102 **University of Arizona Press**
1230 North Park, #102
Tucson AZ 85719
The exhibit will include books of interest to SAA members, and especially highlighting new books for 1990-91
- 311 **University of Nevada, Reno**
Division of Continuing Education, MS 048
Cultural Resources Management
Reno NV 89557
Exhibit will have photos from previous CRM short courses, information about the program and future courses
- 307 **University of New Mexico Press**
1720 Lomas Blvd, NE
Albuquerque NM 87131-1591
The University of New Mexico Press is a scholarly press specializing in the fields of photography, anthropology/archaeology, western history and Latin American studies

208 & 210

University of Oklahoma Press

1005 Asp Avenue
Norman OK 73019-0445

Scholarly books pertaining to the interest of attendees

211

University of Texas Press

PO Box 7819
Austin TX 78713

A wide range of archaeological monographs and scholarly works from related disciplines

104

University of Utah Press

101 University Services Building
Salt Lake City UT 84112

Exhibit of books of interest to scholars and students attending the SAA meeting. Catalogs and order forms offering a 20% discount

109, 111, 113
& 115

USDA Forest Service

12th & Independence Aves, SE
Washington DC 20250

Portable display stands and tabletop displays—both depicting CRM on National Forests throughout the nation

CLARION HOTEL
EXHIBITION HALL
LOBBY LEVEL

SOCIETY FOR AMERICAN ARCHAEOLOGY
APRIL 25 - 27, 1991

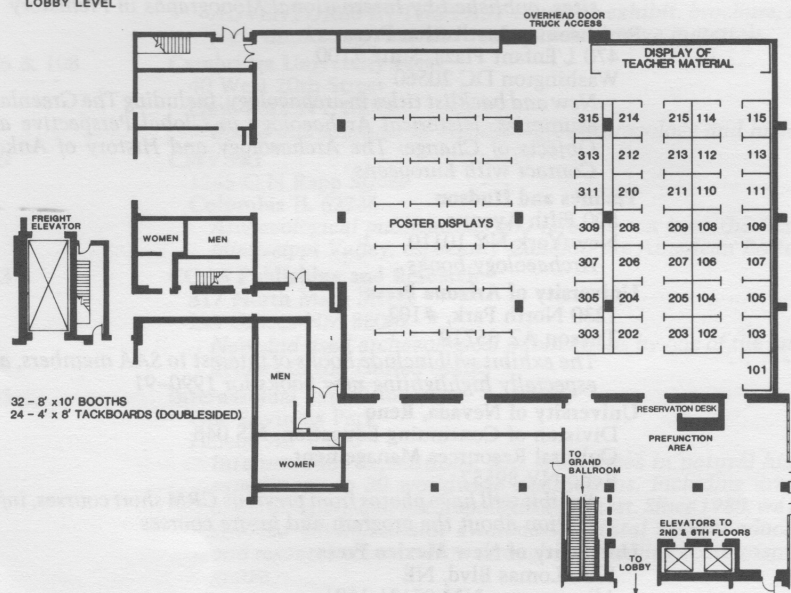

Cambridge University Press

A new paperback edition...

J.G. Frazer

His Life and Work
Robert Ackerman

Landscape, Monuments and Society

The Prehistory of Cranborne Chase
John Barrett, Richard J. Bradley and Martin T. Green, Editors

The Passage of Arms

An Archaeological Analysis of Prehistoric Hoards and Votive Deposits
Richard Bradley

A new paperback edition...

The Decipherment of Linear B

John Chadwick

The Kalahari Environment

David S.G. Thomas and Paul A. Shaw

Classic Maya Political History

Hieroglyphic and Archaeological Evidence
T. Patrick Culbert, Editor

Images of Prehistory

Views of Early Britain
Peter Fowler

Reading the Past

Current Approaches to Interpretation in Archaeology
Second Edition
Ian Hodder

Now in paperback...

Archaeological Thought in America

C.C. Lamberg-Karlovsky, Editor

The Romanization of Britain

An Essay in Archaeological Interpretation
Martin Millet

Thoughtful Foragers

A Study of Prehistoric Decision Making
Steven Mithen

Early Hellenistic Coinage

from the Accession of Alexander to the Peace of Apamea (336-188 BC)
Otto Morkholm Philip Grierson and Ulla Westermark, Editors

The First Millennium A.D. in Europe and the Mediterranean

An Archaeological Essay
Klaus Randsborg

Sumer and the Sumerians

Harriet Crawford

The Evolution of Political Systems

Sociopolitics in Small-scale Sedentary Societies
Steadham Upham, Editor

Archaeology Yesterday and Today

Zdenek Vasicek and Jaroslav Malina

Please stop by the Cambridge Booth to see these and other outstanding titles